

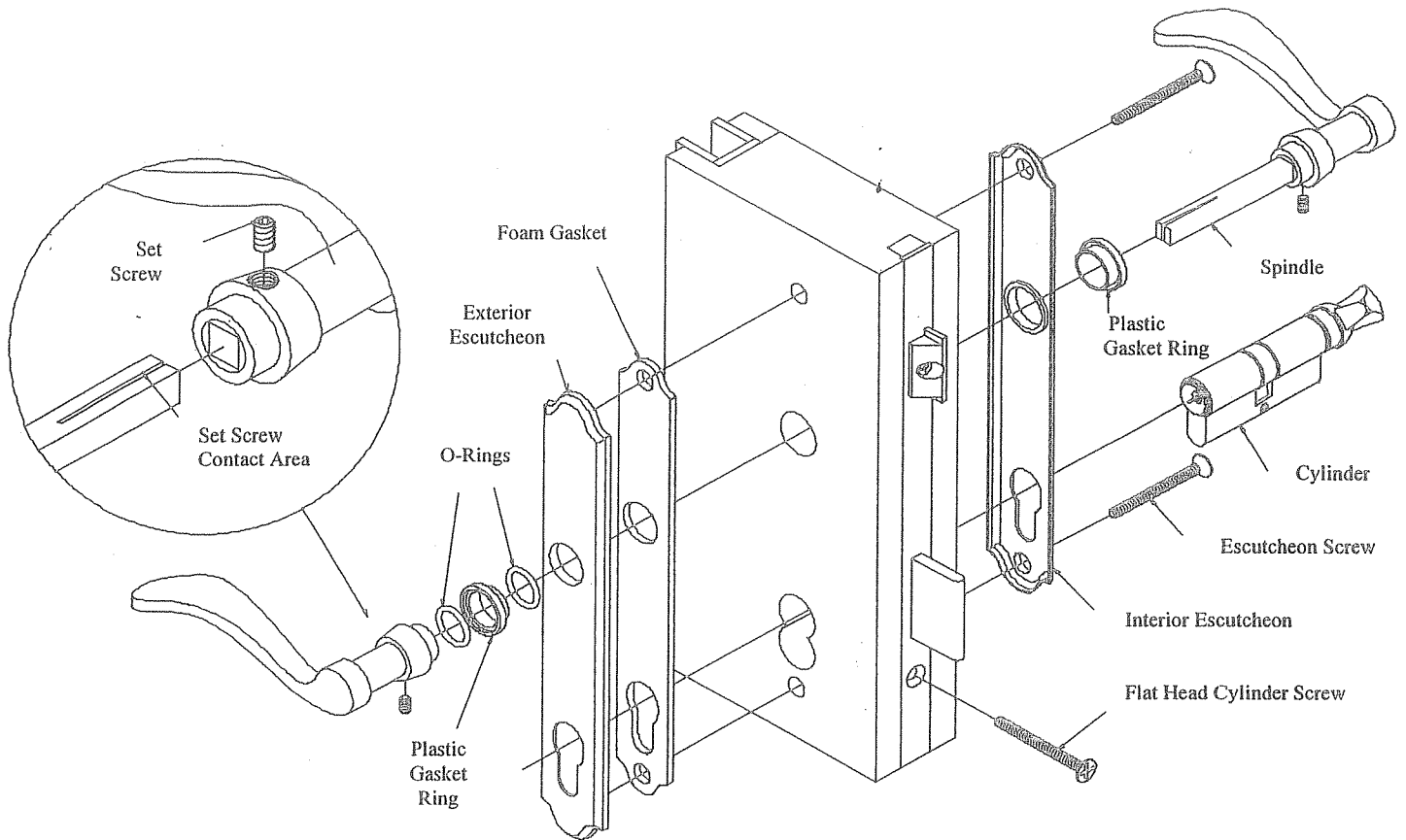

HANDLE SET INSTALLATION INSTRUCTIONS



1. Press the foam gasket onto the exterior escutcheon plate.
2. Install the interior and exterior escutcheon plates and fasten loosely with the enclosed 2" escutcheon screws.
3. Place the rubber o-rings onto each side of one plastic gasket ring and slide it onto the end of the exterior handle. Slide a plastic gasket ring without o-rings onto the interior handle.
4. Install inside and outside lever handles, but do not tighten set screws. Make sure the set screws fit into the slot in the spindle
5. Insert lock cylinder from the inside. Install the flat head cylinder screw through the hole on the side of lock.
6. Tighten the 2" escutcheon plate screws.
7. Push the handles firmly against the escutcheon plates and tighten the set screws with the wrench provided.

Note: If the rubber o-ring's becomes sticky with wear, it can be lubricated with a non-petroleum based lubricant such as silicone or teflon



MULTI-POINT HARDWARE OPERATING INSTRUCTIONS

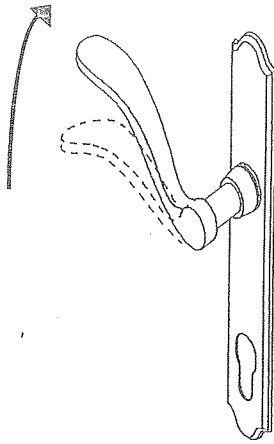

To Lock the Door:

1. Activate all of the locking points by turning the handle upward.
2. Throw the deadbolt by turning either the key or the knob. The door is now completely locked.

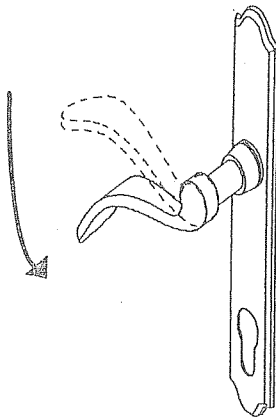

To Unlock the Door:

1. Disengage the deadbolt by turning either the key or the knob.
2. Deactivate all of the locking points by turning the handle downward. The door should now operate normally until locked again.

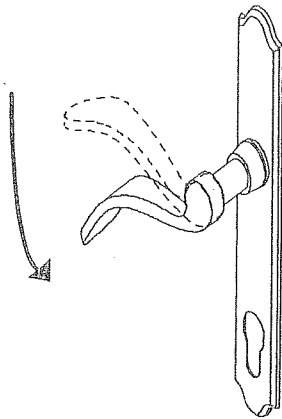

Normal Operation of the Door:

For normal operation of the door when unlocked, simply push the handle down to disengage the latchbolt and open the door.



Care Instructions:

This product has been coated with a weather resistant protective lacquer. To maintain this coating, it should only be cleaned with a soft cloth and without aggressive cleansing agents.

INSTALLATION INSTRUCTIONS 90 DEGREE TURN CYLINDER

1. Loosen set screw (B) on knob using the Allen key. (included)
2. Remove knob (C) from body of cylinder
3. Push the pin (D) down with the auxiliary tool (E) (included). Turn cylinder shaft (A) until the follower (F) pointing down.
4. Holding in this position, insert the cylinder into the door until the follower is engaged into the lock. Insert the key and turn to operate the lock into locking position.
5. In this position, fix knob (C) on cylinder shaft (A) with set screw (B), set screw pointing downwards.
6. Tighten set screw (B). Install cylinder screw.

To Remove cylinder:

Loosen and remove cylinder screw, and repeat 1. – 3. above and remove the cylinder.

