

RACK GEAR OPERATORS & KITS

**ALL
NEW
PRODUCTS!**

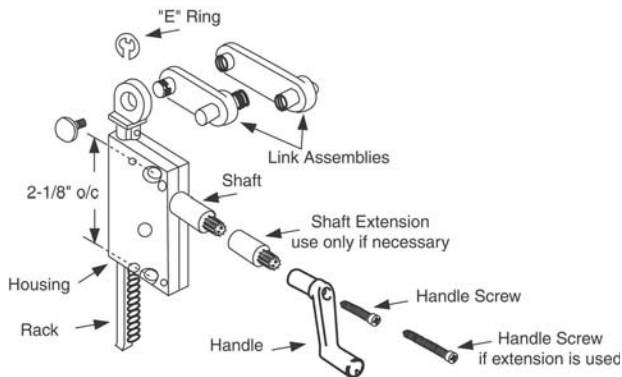

800PK
Operator Kit
1 Per Bag

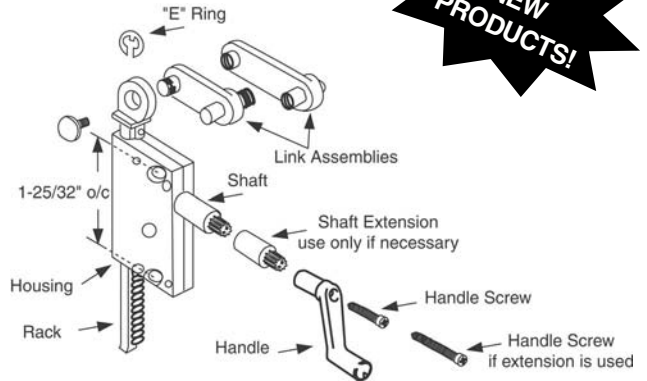

801PK
Operator Kit
1 Per Bag

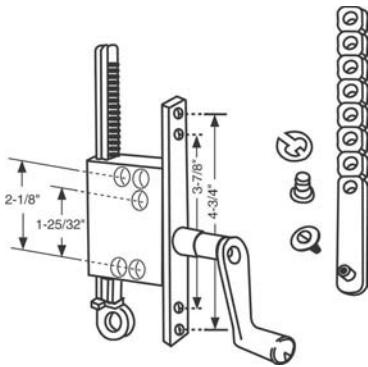

815P
Face Mount Rack Operator
1 Per Bag

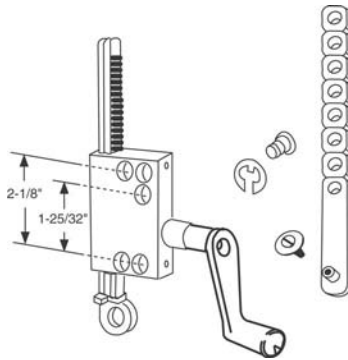

816P
Non-Handed Rack with
Tapped Holes Operator Kit
1 Per Bag

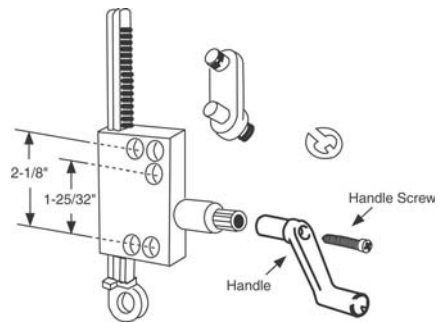

824P
Rack Operator
with Link
1 Per Bag

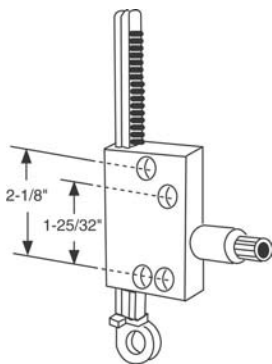

800P
Standard Rack
Operator
1 Per Bag

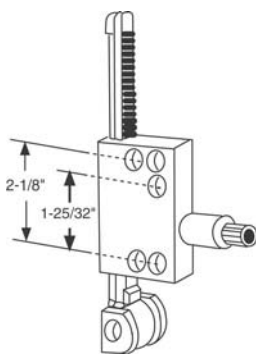

823P
Wide Head Tapped
Operator
1 Per Bag

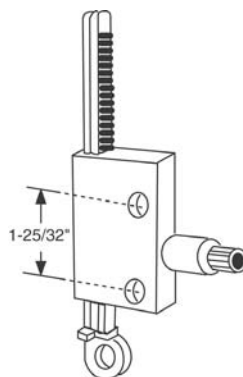

801P
Standard Rack
Operator
1 Per Bag

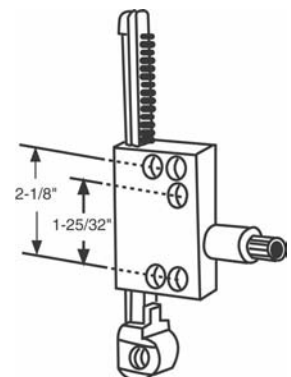

819P
Face Mount Rack
Operator
1 Per Bag

TOLL FREE 800-352-0800

2003, SBI®

strybuc

i

[Return to Table of Contents](#)

CENTER MOUNT OPERATORS & KITS

**ALL
NEW
PRODUCTS!**

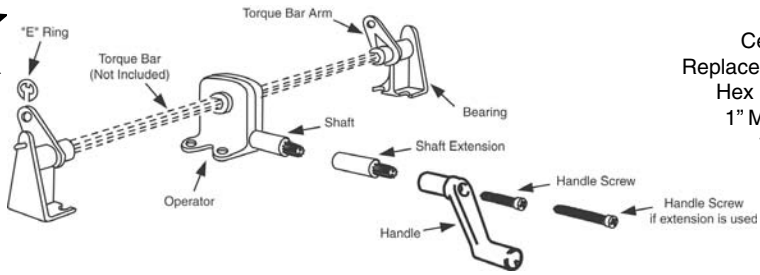

802PK
Center Mount
Replacement Operator Kit
Hex 3/8" - 1-1/4" x
1" Mtg. Hole Dim.
1 Per Bag

803PK
Center Mount
Replacement Operator Kit
Square 5/16" - 1-1/4" x
1" Mtg. Hole Dim.
1 Per Bag

808PKR - Right Hand (Shown)
808PKL - Left Hand (Opposite)
Replacement Operator Kit
1 Per Bag

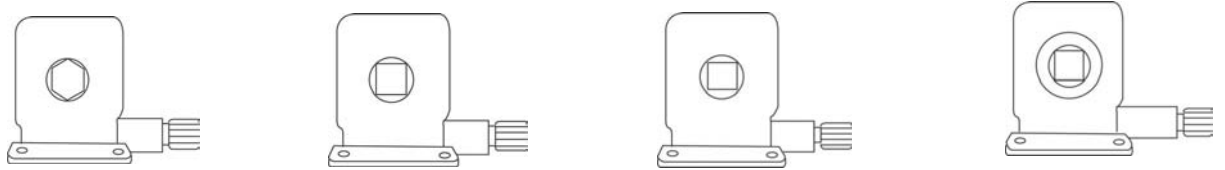
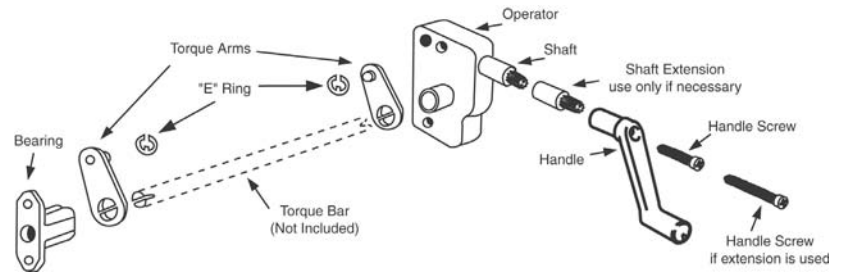

802P
Center Mount - Hex 3/8"
1-1/4" x 1" Mtg. Hole Dim.
1 Per Bag

803P
Center Mount - Square 5/16"
1-1/4" x 1" Mtg. Hole Dim.
1 Per Bag

811P
Center Mount - Square 1/4"
1" x 11/16" Mtg. Hole Dim.
1 Per Bag

812P
Center Mount - Square 5/16"
1" x 11/16" Mtg. Hole Dim.
1 Per Bag

SIDE MOUNT OPERATORS & KITS



813P
Center Mount - Hex 1/4"
1" x 11/16" Mtg. Hold Dim.
1 Per Bag

778P
Trailer Operator - Square 1/4"
1-11/32" x 13/16"
1 Per Bag

804PR - Right Hand (Shown)
804PL - Left Hand
Side Mount Operator
1 Per Bag

808PR - Right Hand (Shown)
808PL - Left Hand
Side Mount Operator
1 Per Bag

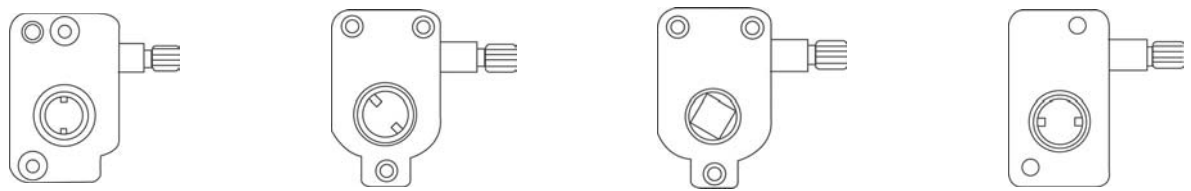

735P - Right Hand (Shown)
736P - Left Hand
Side Mount Operator
1 Per Bag

747PR - Right Hand (Shown)
747PL - Left Hand
Awning Type Operator
1 Per Bag

749PR - Right Hand (Shown)
749PL - Left Hand
Awning Type Operator
1 Per Bag

787PR - Right Hand (Shown)
787PL - Left Hand
Side Mount Operator with
Long Shoulder
1 Per Bag

SIDE MOUNT OPERATORS, KITS & HANDLES

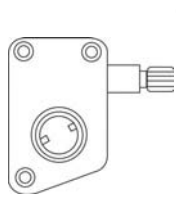

761P - Right Hand (Shown)
762P - Left Hand
 Slant Sill Operator
 1 Per Bag

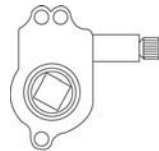

Original

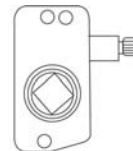

Replacement

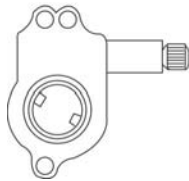

Original

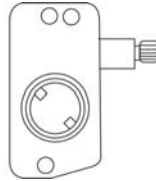

Replacement

1712P - Right Hand (Shown)
1713P - Left Hand
 Side Mount Operator
 1/4" Hub Projection
 1 Per Bag

1716P - Right Hand (Shown)
1717P - Left Hand
 Side Mount Operator
 1/2" Hub Projection
 1 Per Bag

1718P - Right Hand (Shown)
1719P - Left Hand
 Side Mount Operator
 11/16" Hub Projection
 1 Per Bag

CRANK HANDLES - 5/16" SPLINE

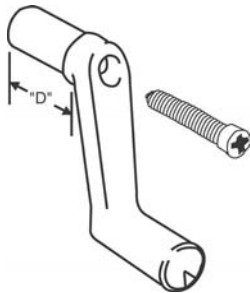

| Part Number | Material | "D" Dim. | Packaging |
|-----------------|----------------|----------|------------|
| 712P BLK | Black Plastic | 3-3/16" | 25 Per Bag |
| 748P BLK | Black Plastic | 1-3/8" | 25 Per Bag |
| 750P BLK | Black Plastic | 2-1/4" | 25 Per Bag |
| 771P BLK | Black Plastic | 2-1/2" | 25 Per Bag |
| 783P | Die Cast Metal | 5/16" | 25 Per Bag |
| 795P | Die Cast Metal | 1-3/4" | 25 Per Bag |
| 796P | Die Cast Metal | 3-1/2" | 25 Per Bag |
| 838P BLK | Black Plastic | 1" | 25 Per Bag |
| 881P BLK | Black Plastic | 1-3/4" | 25 Per Bag |
| 889P | Die Cast Metal | 1" | 25 Per Bag |

TEE HANDLES - 5/16" SPLINE

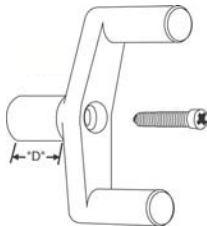

| Part Number | Material | "D" Dim. | Packaging |
|-------------|----------------|----------|------------|
| 776P | Die Cast Metal | 1" | 25 Per Bag |
| 837P | Black Plastic | 3/4" | 25 Per Bag |

KNOB HANDLE - 5/16" SPLINE

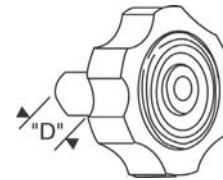

| Part Number | Material | "D" Dim. | Packaging |
|------------------|---------------|----------|------------|
| 743P BLK | Black Plastic | 1/2" | 25 Per Bag |
| 743PE BLK | Black Plastic | 7/8" | 25 Per Bag |
| 743P WHT | White Plastic | 1/2" | 25 Per Bag |
| 743PE WHT | White Plastic | 7/8" | 25 Per Bag |

WINDOW CRANK HANDLE EXTENSIONS

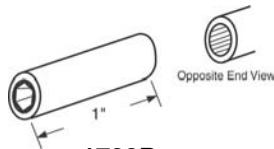

1729P Metal
 5/16" Hex to 5/16" Spline
 25 Per Bag

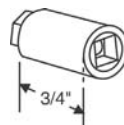

774P Metal
 Square to Square
 25 Per Bag

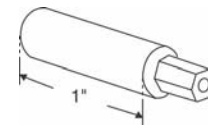

847P Metal
 5/16" Hex to 5/16" Hex
 25 Per Bag

HANDLE EXTENSIONS - 5/16" SPLINE TO SPLINE

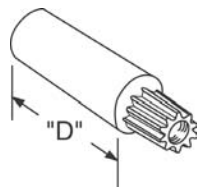

| Part Number | Material | "D" Dim. | Packaging |
|-------------|----------|----------|------------|
| 831P | Die Cast | 1/2" | 25 Per Bag |
| 832P | Die Cast | 7/8" | 25 Per Bag |
| 833P | Die Cast | 1-1/8" | 25 Per Bag |
| 834P | Die Cast | 2" | 25 Per Bag |

TOLL FREE 800-352-0800

2003, SBI®

strybug

ROOF VENT & JALOUSIE OPERATORS

ALL NEW PRODUCTS!

TYPICAL ROOF VENT OPERATIONS

2-15/16" Center to Center Mount Holes

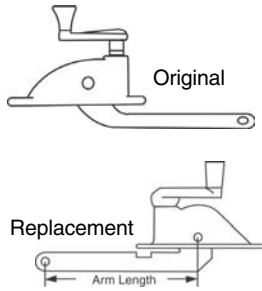
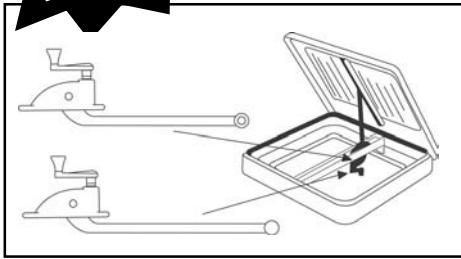

| Replacement Part Number | Arm Length | Finish | Includes |
|-------------------------|------------|----------|---------------|
| 794PK | 4" | Aluminum | E, F |
| 805PK | 1-1/2" | Aluminum | E, F, G, I, J |
| 806PK | 5-3/8" | Aluminum | E |
| 807PK | 7-11/16" | Aluminum | E |
| 814PK | 6" | Aluminum | E |
| 898PK | 5" | Aluminum | E,F,H |

Packed 1 Kit Per Bag With Screws

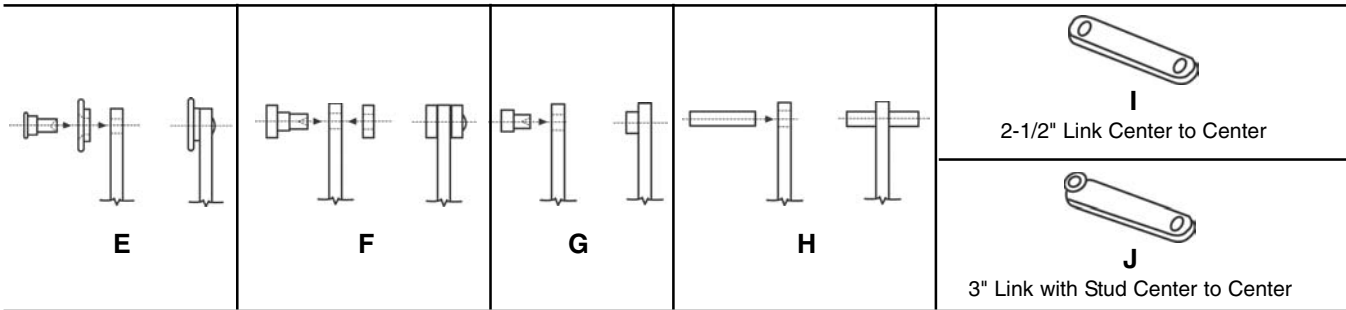

JALOUSIE OPERATORS

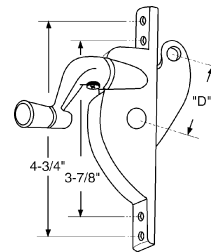
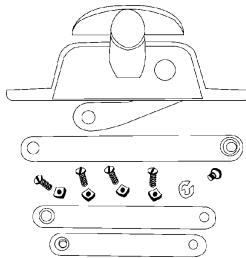

| Part # | Packaging | Finish | Description |
|----------------|-----------|----------|-------------|
| 4000PK | Bagged | Aluminum | Universal |
| 4000PKW | Bagged | White | Universal |

Replacement kits fit 95% of all Jalousies
1 Per Card/1 Per Bag

| Part # | Packaging | Finish | Handed | Link | "D" |
|-------------|-----------|----------|--------|---------|--------|
| 208P | Bagged | Aluminum | LH | | 1-1/2" |
| 209P | Bagged | Aluminum | RH | | 1-1/2" |
| 242P | Bagged | Aluminum | RH | | 2" |
| 243P | Bagged | Aluminum | LH | | 2" |
| 809P | Bagged | Aluminum | RH | | 1-1/4" |
| 810P | Bagged | Aluminum | LH | | 1-1/4" |
| 882P | Bagged | Aluminum | LH | 3" Link | 1-1/2" |
| 883P | Bagged | Aluminum | RH | 3" Link | 1-1/2" |

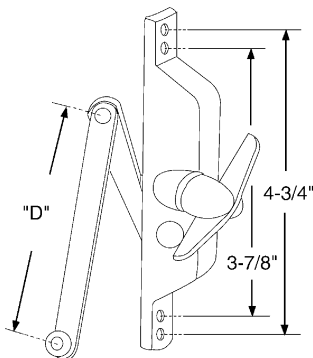

| Part # | Packaging | Finish | Description | "D" |
|---------------|-----------|----------|-------------|----------|
| 300P | Bagged | Aluminum | Air Control | 3-1/32" |
| 300PB | Bagged | Bronze | Air Control | 3-1/32" |
| 300PW | Bagged | White | Air Control | 3-1/32" |
| 301P | Bagged | Aluminum | Stanley | 3-11/32" |
| 302P | Bagged | Aluminum | ABC | 1-23/32" |
| 303P | Bagged | Aluminum | Pan Am | 3-5/8" |
| 303PB | Bagged | Bronze | Pan Am | 3-5/8" |
| 303PKA | Bagged | Aluminum | Pan Am | 3-5/8" |
| 303PKW | Bagged | White | Pan Am | 3-5/8" |
| 303PW | Bagged | White | Pan Am | 3-5/8" |
| 434P | Bagged | Aluminum | Tucker | 3-5/8" |
| 434PW | Bagged | White | Tucker | 3-5/8" |
| 441P | Bagged | Aluminum | Look | 3-5/8" |
| 464P | Bagged | Aluminum | Superior | 4" |
| 464PB | Bagged | Bronze | Superior | 4" |
| 464PW | Bagged | White | Superior | 4" |
| 854P | Bagged | Aluminum | Hehr | 3-1/32" |
| 1421P | Bagged | Aluminum | Crown | 4-1/2" |