

Knob/Push Pull Latch Sets

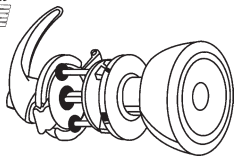

Tulip Knob Latch, Single Hole

Part #	Color
17-52	Aluminum

- Fits doors 1" - 1-1/4" thick.
- Resilient strike
- Installs in single hole bore 1-1/4" diameter.

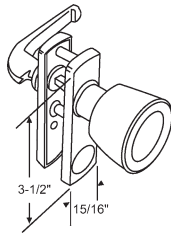

Tulip Knob Latch

Part #	Color
17-59	Black
17-60	Aluminum

- Resilient strike
- 1-3/4" installation hole spacing
- Fits doors 1" - 1-1/4" thick.

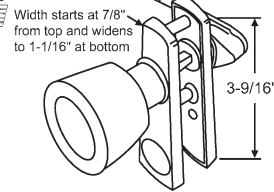

Tulip Knob Latch "No Lock Out" Feature

Part #	Color
17-61	Aluminum

- Solid strike
- 1-3/4" installation hole spacing
- "No Lock Out" feature prevents accidental lock out.
- Fits doors 7/8" - 1-1/4" thick.

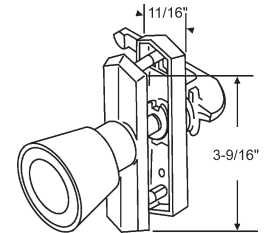

Tulip Knob Latch

Part #	Color
17-50	Aluminum
17-51	Black

- Resilient strike
- 3" installation hole spacing
- Fits doors 1" - 1-1/4" thick.

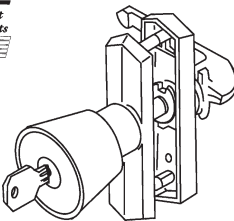

Tulip Key-In-Knob Lock (3")

Part #	Color
900-7320	Aluminum

- Resilient strike
- 3" installation hole spacing
- Key lock for extra security
- Fits doors 7/8" - 1-3/8" thick.

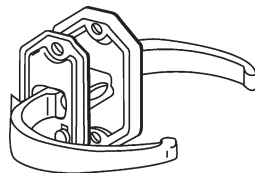

Push Pull Latch

Part #	Color
17-67	Aluminum

- Popular for wood door applications.
- Resilient strike
- Installs in 1" diameter single hole bore.
- Fits Doors 1" - 1-1/4" Thick.

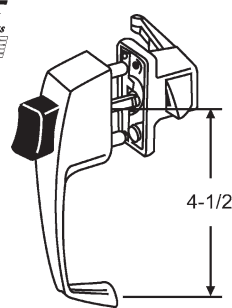

Part #	Color
17-95	Aluminum
17-96	Black

- Solid strike
- 1-1/2" installation hole spacing
- "No Lock Out" feature prevents accidental lock out.
- Fits doors 1" - 1-1/4" thick.

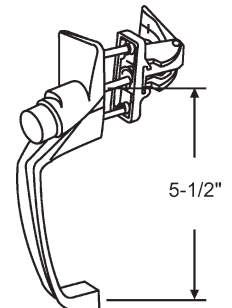

Part #	Color
17-65	Aluminum
17-66	Black

- Resilient strike
- 1-1/2" mounting hole spacing
- Fits doors 1" - 1-1/4" thick.
- Tie down type

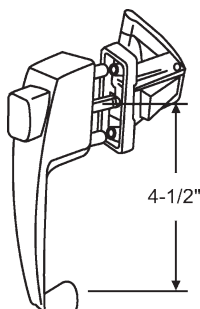

Part #	Color
17-58	Aluminum
17-58B	Black
17-58W	White

- Resilient strike
- 1-3/4" installation hole spacing
- Fits doors 1" - 1-1/4" thick.
- Tie down type

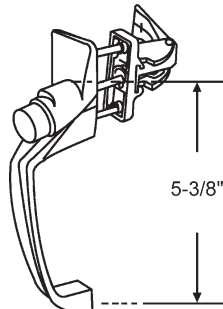

Part #	Color
17-82A	Aluminum
17-82	Black
17-82W	White

- Resilient strike
- 1-3/4" mounting hole spacing
- Fits doors 5/8" - 1-1/4" thick.
- Tie down type

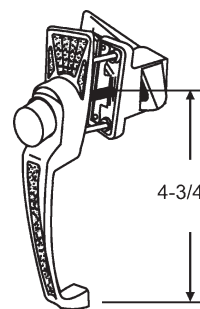

Part #	Color
17-73	Aluminum
17-72	Black

- Solid strike
- 1-3/4" installation hole spacing
- "No Lock Out" feature prevents accidental lock out.
- Fits doors 5/8" - 1-1/4" thick.

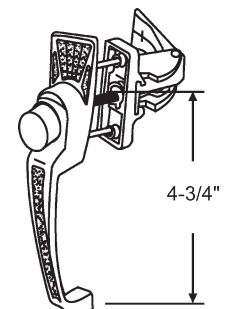

Part #	Color
17-53	Aluminum
17-54	Black

- Resilient strike
- 1-3/4" installation hole spacing
- Fits doors 1" - 1-1/4" thick.

Storm Door Hardware

Push Button Latch Set

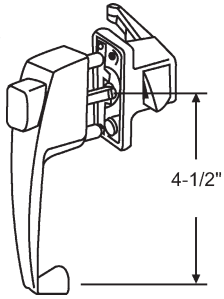

Part #	Color
900-7339	Aluminum
900-7339BL	Black

Heavy Duty Push Button Latch

- Solid strike
- 1-3/4" installation hole spacing
- "No Lock Out" feature prevents accidental lock out.
- Fits doors 1" - 1-1/4" thick.

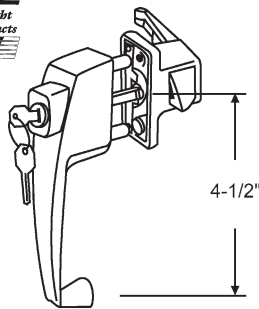

Part #	Color
900-7339KBL	Black

Heavy Duty Push Button Latch

- Solid strike
- 1-3/4" installation hole spacing
- "No Lock Out" feature prevents accidental lock out.
- Furnished with 2 Brass Keys
- Fits Doors 1" - 1-1/4" Thick.

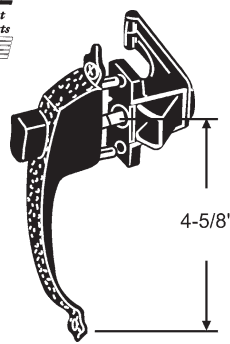

Part #	Color
900-14570	Black

Colonial Heavy Duty Push Button Latch

- Solid strike
- 1-3/4" installation hole spacing
- "No Lock Out" feature prevents accidental lock out.
- Fits Doors 1" - 1-1/4" Thick.

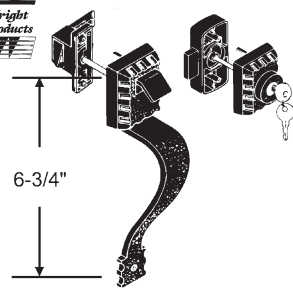

Push Button Set with Deadbolt

Part #	Color
900-13554K	Black

Deadbolt Only

Part #	Color
900-13554DB	Black

- Mounting hole center 1-3/4"
- Fits doors 1" - 1-1/4" Thick.

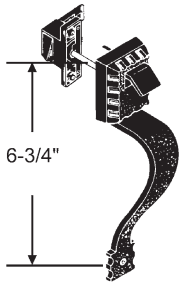

Push Button Set Only

Part #	Color
900-13554	Black

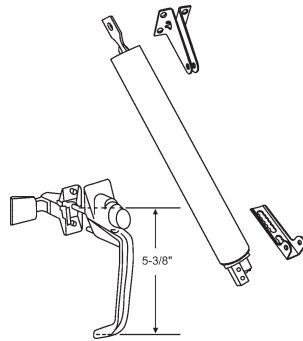

Part #	Color
19-709B	Black
19-709AL	Aluminum

Storm Door Hardware Kit. Does Not Include Chain

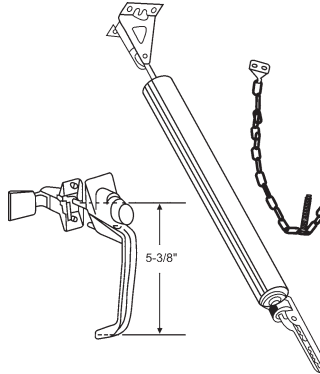

Part #	Color
19-199B	Black

Storm Door Hardware Kit with Chain Steel Tube

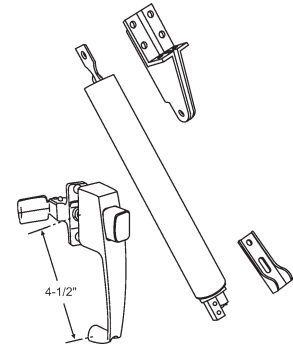

Part #	Color
19-376W	White
19-376BR	Bronze

Corrosion Resistant. Ideal for Coastal Applications. Includes Pneumatic Door Closer, Heavy Duty Plastic Jamb Bracket, Push-Button Latch with 1-3/4" Installation Hole Spacing, Screws, and Instructions

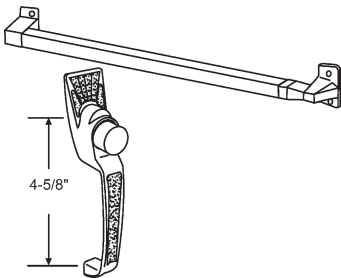

Touchbar™ Latch Set

Part #	Color
17-63-2	Aluminum
17-63-1	Black
17-63-3	White

- For all outswinging doors up to 36" wide.
- Protects against glass and screen damage
- "No Lock Out" latch, solid strike

Ideal

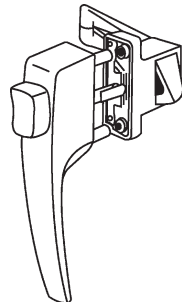

Push Button Latch - No Key

Part #	Color
17-70	Aluminum
17-71	Black

- Solid strike
- 1-3/4" installation hole spacing
- "No Lock Out" feature prevents accidental lock out.
- Fits doors 5/8" - 1-1/4" thick.

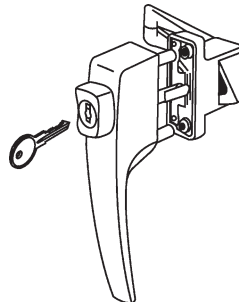

Push Button Latch with Key

Part #	Color
17-70K	Aluminum
17-71K	Black

- Solid strike
- 1-3/4" installation hole spacing
- "No Lock Out" feature prevents accidental lock out.
- Fits doors 5/8" - 1-1/4" thick.

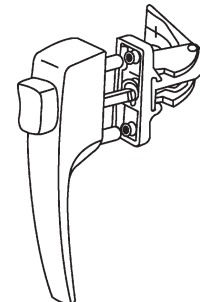

Push Button Latch

Part #	Color
17-56	Black

- Resilient strike
- 1-3/4" installation hole spacing
- Fits doors 1" - 1-1/4" thick.

Push Button Latch Set

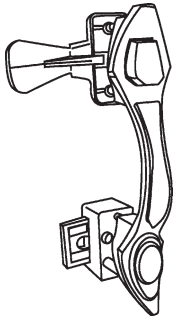

Quincy Push Button Latch Set

Part #	Color
17-127	Brass Finish
17-127AB	Antique Brass

- Elegant Styled Handle with Interior Deadbolt
- "No Lock Out" Feature
- 1-3/4" Hole Spacing
- Installs in six 5/16" Diameter Holes
- Handle: 8"
- Reversible

VP Pull Handle Set

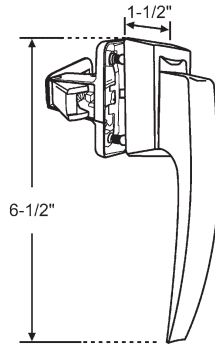

Part #	Color
17-191-1	Black
17-191-3	White

1-3/4" Hole Spacing. Operates with a single natural smooth action.

Ideal

Lever Latch Sets

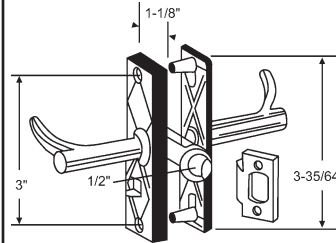

Storm & Screen Latch without Key

Part #	Color
900-14851	Aluminum
900-14851B	Black

- Designed to Fit Most Combination Screen and Storm Doors
- Reversible • Slide Lock for Extra Security
- Accepts 7/8" to 1-1/4" Door Thickness
- 3/4" Backset
- Mounting Hole Center 3"

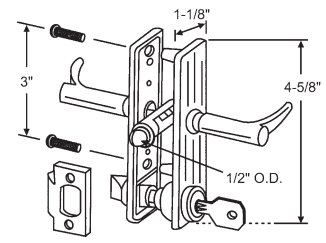

Storm & Screen Latch with Key

Part #	Color
900-14851K	Aluminum
900-14851BK	Black

- Designed to Fit Most Combination Screen and Storm Doors
- Reversible • Slide Lock for Extra Security
- Accepts 7/8" to 1-1/4" Door Thickness
- 3/4" Backset
- Mounting Hole Center 3"

Beautifully Designed, Classically Styled Lever Handle with an Elegantly Sculptured Escutcheon

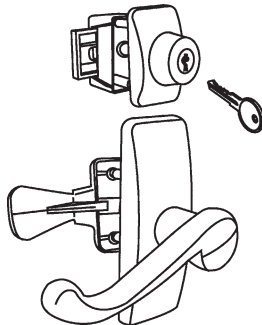

Lever Latch Set with Keyed Deadbolt

Part #	Color
17-25BK	Black
17-25WK	White
17-25BR SK	Brass

Comes Furnished with Black Inside Latch.

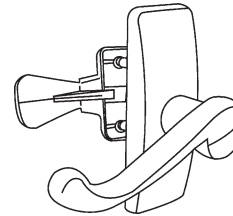

Lever Latch Only

Part #	Color
17-25B	Black
17-25W	White
17-25BRS	Brass

Comes Furnished with Black Inside Latch.

- Positive Key Locking Deadbolt for Security • Strong Leveling Return Spring Eliminates Lever Droop • Fits Doors 3/4" to 1-1/4" Thick
- 1-3/4" Hole Spacing - Upper and Lower Trims • Install in 5/16" Diameter Holes • For Doors with a Stile Greater Than 2" • Escutcheon Width 1-5/8"
- Escutcheon Length: Upper 2-3/4", Lower 4-7/16" • Lever Projection 2-1/8" (From Door) • Backset - Variable with Several Strike Options Included
- Lever Length from Center of Hub: 4" • Non-Handed, Designed to Complement Both Right and Left Hand Doors • Escutcheon Plate Included for Use with Inside Latch.

Trailer Latch Sets

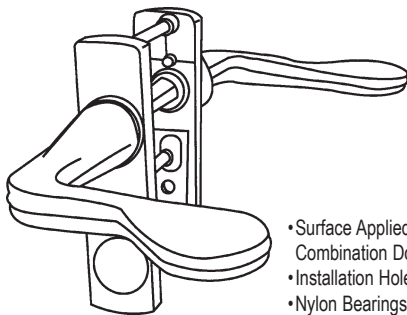

Inswing Door Latch Set

Part #	Color
900-7323	Aluminum
900-7323B	Black

- Surface Applied Latch for Inswinging Combination Doors 5/8" to 1-3/8" Thick
- Installation Hole Spacing 7/8"
- Nylon Bearings Provide Lifetime Lubrication
- Features a Night Lock and an Easy Latching Resilient Strike
- Reversible for Right and Left Hand Doors and Fits Stiles as Narrow as 1-3/8"
- Installs in Three 1/4" Holes
- Inside Lever Projection is 3"
- Outside Lever Projection is 3-3/4"
- Mounts 1-3/4" Center to Center

Ideal

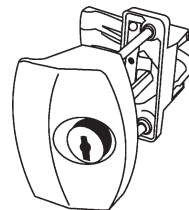

Part #	Color
17-21KA	Aluminum

Low Profile Trailer Lock Set with Key (Entrance)

- For Outswinging Wood or Metal Doors
- Fits 3/4" to 1-1/4" Doors
- Installation Hole Spacing 1-3/4"
- Installs in Two 5/16" Holes and One 7/8" Hole
- Use Wherever a Keyed Locking Unit is Required
- "No Lock Out" Feature

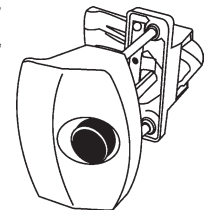

Part #	Color
17-21B	Black

Low Profile Trailer Lock Set with Push Button (Privacy)

- For Outswinging Wood or Metal Doors
- Fits 1/2" to 1-1/4" Doors
- Installation Hole Spacing 1-3/4"
- Installs in Three 5/16" Holes
- Emergency Entrance can be Made from the Outside by Using a Coin or Screwdriver
- "No Lock Out" Feature

Storm Door Hardware

Closers

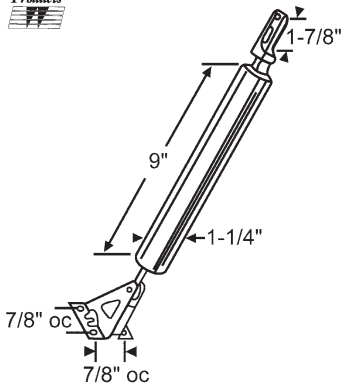

Part #	Color
18-52	Aluminum
18-53	Black
18-52W	White

Pneumatic Door Closer

- For Light Weight Screen Doors
- For Wood or Metal Doors
- For Outswinging Doors
- Full 90° Opening
- Adjustable Closing Speed
- Factory Lubricated

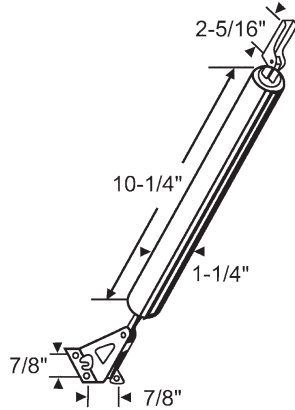

Part #	Color
18-63	Aluminum
18-62	Black
18-62W	White

Economy Air Closer

- For Doors up to 1-1/4" Thick
- Adjustable Closing Power

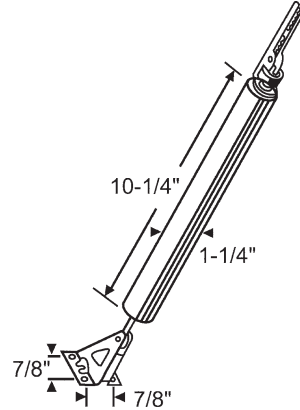

Part #	Color
18-65	Aluminum
18-64	Black
18-64W	White

Silent Action Door Closer

- For Doors up to 1-1/4" Thick
- Permanently Lubricated
- Adjustable Latching Power
- Adapter Plates to Cover Old Holes

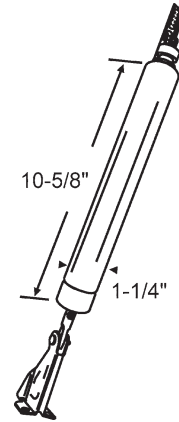

Part #	Color
18-71	Aluminum
18-71B	Black

Pneumatic Door Closer

- For Doors up to 1-1/4" Thick
- Temperature Changes Do Not Affect Closing Action
- Permanently Lubricated
- Automatic Hold Open/Easy Close Feature

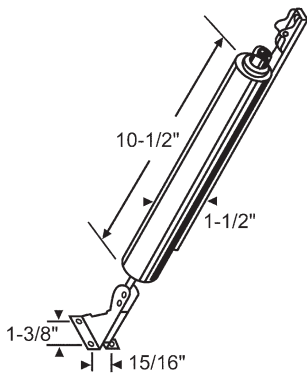

Part #	Color
18-58	Aluminum
18-57	Black

"Smooth Air" Heavy Duty Door Closer

- For Storm and Screen, Jalousie or Interior Doors up to 1-3/4" Thick
- Has Two Times the Power of Standard Closers at Latching Position
- Permanently Lubricated
- Adjustable Speed Control

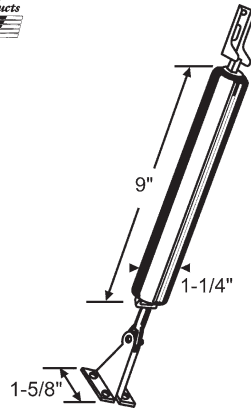

Part #	Color
18-103	Aluminum
18-102	Black
18-102W	White

820 Pneumatic Door Closer

- For Light Storm Doors of Wood or Metal
- Full 90° Opening
- Two-Hole End Plug for Summer and Winter Adjustment
- Adjustable Closing Speed
- Total Length when Mounted Per Instructions: 11-1/16"

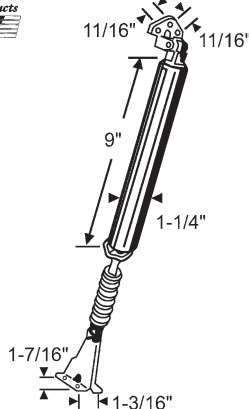

Part #	Color
18-61	Aluminum
18-60	Black
18-60W	White

Pneumatic Door Closer

- For Wood or Metal Doors
- Full 90° Opening
- Two-Hole End Plug for Summer and Winter Adjustment
- Adjustable Closing Speed
- External Spring to Prevent Rod Bending
- Packaged with Narrow and Wide Bracket
- Total Length when Mounted Per Instructions: 13-7/16"

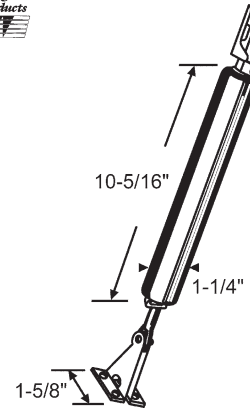

Part #	Color
18-114	Aluminum
18-112	Black
18-113	White

920 Pneumatic Door Closer

- For Wood or Metal Doors
- Full 90° Opening
- Two-Hole End Plug for Summer and Winter Adjustable Latching Power
- Adjustable Closing Speed
- Total Length when Mounted Per Instructions: 12-11/16"

Closers

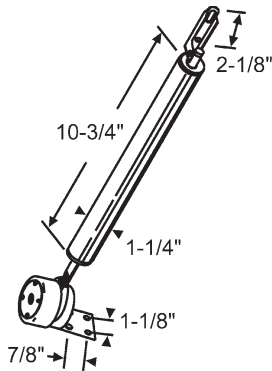

Part #	Color
18-50	Aluminum
18-50B	Black

Deluxe Heavy Duty Door Closer

- Designed for Heavy Combination Storm and Screen Doors, Light Exterior Doors and Interior Doors
- For Right or Left Hand Inswinging or Outswinging Doors.
- Manual Hold Open Feature
- Available in Black and Aluminum
- Packed with Installation Instructions (Instructions also available online)

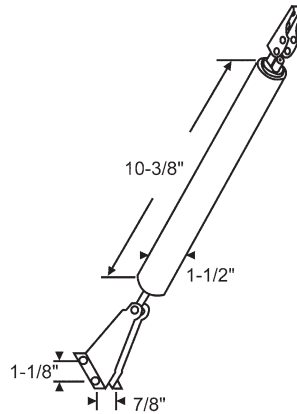

Part #	Color
18-97	Aluminum
18-97B	Black
18-97W	White
18-97G	Gold

150 Heavy Duty Torsion Pneumatic Door Closer

- For Wood or Metal Doors
- Full 90° Opening
- Two-Hole End Plug for Summer and Winter Adjustment
- Adjustable Closing Speed
- Internal Bumper for Prevention of Rod Bending
- Total Length when Mounted Per Instructions: 12-3/4"

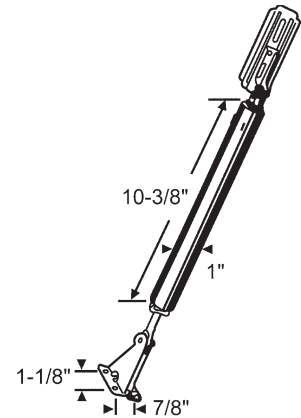

Part #	Color
18-55	Aluminum
18-56	Black

H440 Hydraulic Door Closer

- Hydraulic Mechanism Provides Smooth "No Bounce" Action
- For Wood or Metal Doors
- Full 90° Opening
- Two-Hole End Plug for Summer and Winter Adjustment
- Adjustable Closing Speed by Rotating the Tube
- Aluminum Tube Assembly
- Total Length when Mounted Per Instructions: 12-11/16"

Inside Latches

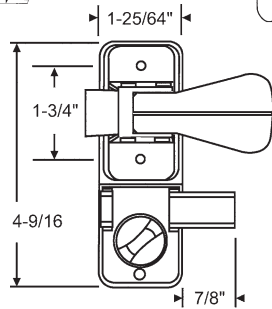

Inside Latch and Deadbolt

Part #	Color
17-135	Black

Deadlock Only

Part #	Color
17-160	Black

- Durable, Heavy-Duty Design
- 1-3/4" Installation Hole Spacing
- Installs in Three 5/16" Holes
- Spring Loaded Nose for use with Z-Bar or Solid Strike
- Latch Assembly and Deadbolt are Reversible
- Can Replace Lever, Knob or Push Button Latch Designs

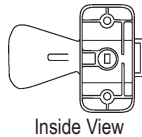

Inside View

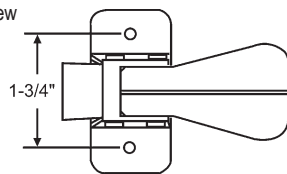

Inside Latch Only

Part #	Color
17-140	Black

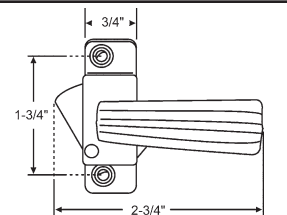

Part #	Color
17-1	Black
17-2	Aluminum

- For all Outswinging Doors 5/8" to 1-1/4" thick
- "No Lock Out" Feature
- 1-3/4" Mounting Hole Spacing
- Installs in Three 5/16" Holes
- Has a Spring Loaded Nose so a Solid Strike is Required

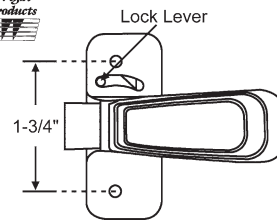

- Installs in Three 5/16" Holes
- Has a Spring Loaded Nose so Z-Bar or Solid Strike is Required
- "No Lock Out" Feature

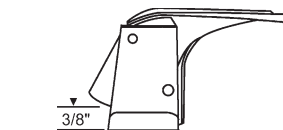

Part #	Color
17-174	Black

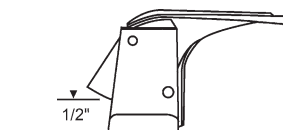

Part #	Color
17-18	Black

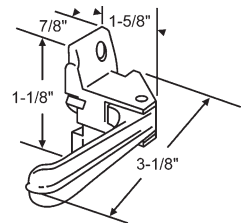

Part #	Color
17-3	Black

1-3/4" Mounting Hole Spacing.
Standard Latch

Key Locks

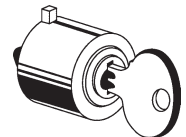

Part #	Color	Converts Handles
19-124	Aluminum	17-53, 17-54
19-125	Black	17-65, 17-66

Converts Latches to Key Locking Sets

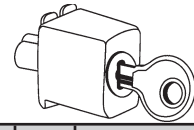

Part #	Color	Converts Handles
19-127	Black	17-56, 17-71, 17-96, 900-7339B, 900-7340

Converts Latches to Key Locking Sets

Storm Door Hardware

Panel Clips and Thumb Screws

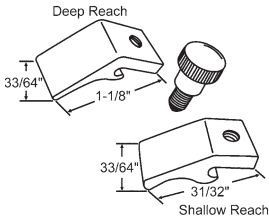

Part #	Color
19-465	White
19-465B	Black

Storm/Screen Door Panel Clip Kits . Includes 4 Each, 2 Styles (Deep and Shallow Reach) of Nylon Clips and 4 Aluminum Screws 8/32" x 1/4" (12pcs. Total)

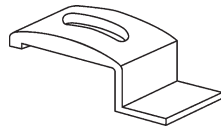

Part #	Color
19-100	Aluminum
19-108	White
19-109	Brown
19-109BLK	Black
19-109BZ	Bronze

1/4" Offset. Metal

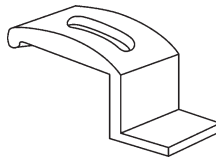

Part #	Color
19-102	Aluminum
19-110	White
19-111BLK	Black
19-111BRZ	Bronze

3/8" Offset. Metal

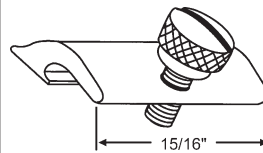

Part #	Color
900-8004BK	Black
900-8004BR	Bronze

Metal

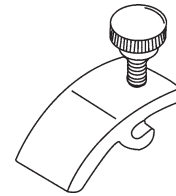

Part #	Color
19-122	Aluminum
19-112	White
19-113	Brown

1/4" Offset. Metal

Strikes

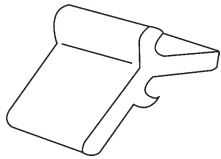

Part #	Color
19-129	White

Nylon

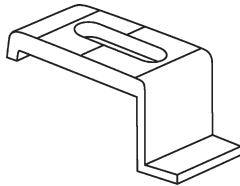

900-14558
Storm Door Clip
White

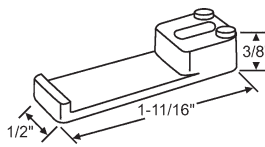

900-6759
Storm Door Clip
White

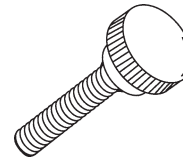

Part #	Color
19-116	Aluminum
19-123	White

8-32 x 9/16". Aluminum

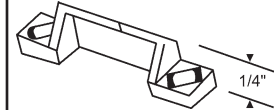

Part #	Color
19-185A	Aluminum
19-185B	Black

No Lock Out. Zinc Solid

Shims

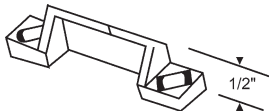

Part #	Color
19-197A	Aluminum
19-197B	Black

No Lock Out. Zinc Solid

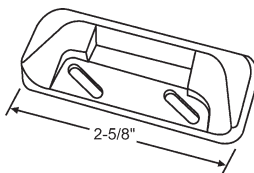

19-227
Black Nylon

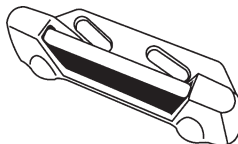

Part #	Color
19-194A	Aluminum
19-194B	Black

3/4" High Profile. Resilient
Wright Products

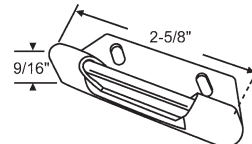

Part #	Color
19-300B	Black
19-300AL	Aluminum
19-300W	White

9/16" High Profile. Resilient
Wright Products

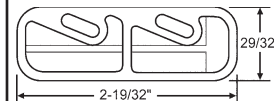

19-196
1/16" Shim (plastic)
Gray



19-186G
1/8" Shim (plastic)
Gray

Push Button



19-128
Metal Breakaway Spindle
with Spring

Door Chain

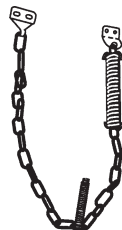

19-106
Includes Hold-Up Spring to
Prevent Chain from Hitting Door
and Scratching Glass.
Includes All Necessary Hardware

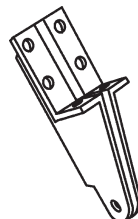

Part #	Color
19-332W	White
19-332B	Black
19-332FBN	Florida Brown

Florida Jamb Bracket. Plastic.

Bracket

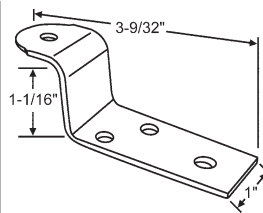

Part #	Color
900-16276A	Aluminum
900-16276B	Black

Steel Top Jamb Door Closer
Bracket.

Screen Spine

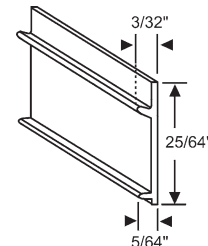

66-61X
Vinyl Screen Spine. Black,
100' Roll
Forever Door