

Aluminum Awning Window Torque Bar Assemblies

Typical Torque Bar Assembly

Many Types in Stock

Minimum Order Required
for Non-Stocked Items

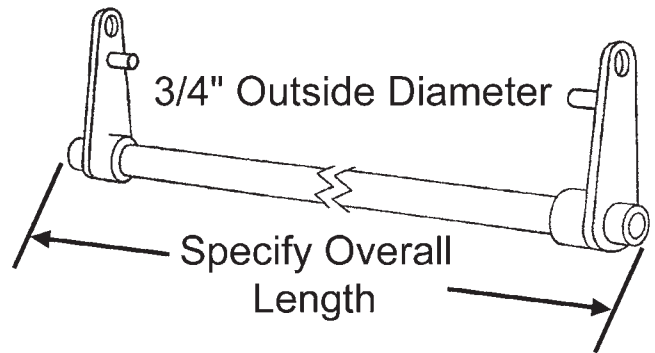

Part #	Manufacturer
ATB 1	Yale Ogron
ATB 3	Superior
ATB 11	Airelok
ATB 16	Tropical
ATB 20	Stanley 45
ATB 23	Pan Am
ATB 24	ABC
ATB 26	Crown
ATB 30	Tucker

Part #	Manufacturer
ATB 34	Keller/Air Control
ATB 35	Old Ware
ATB 37	Miami Highlander
ATB 39	Wallace
ATB 45	Stanley
ATB 46	Ludman
ATB 49	Old Crossly
ATB 60	Old, Old, Crossly w/Gear
ATB 62	Old Old Tucker

Ordering Instructions: Identify manufacturer, then specify overall length, including torque bar arm.

Casement and Awning Operator Brackets

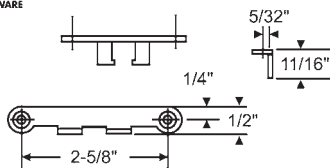

Part #	Description
39-364	E-Gard Finish

Sash Hook

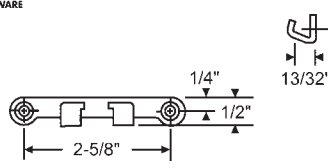

Part #	Description
39-1	E-Gard Finish
39-1CG	CoastGard Finish

Sash Hook for Lever Operator

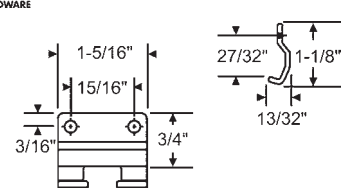

39-241
Center Hook for Lever Operator

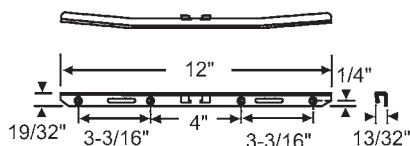

Part #	Description
39-2	E-Gard Finish
39-2CG	CoastGard Finish

Torsion Bar for Lever Operator

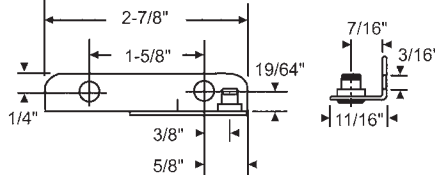

Part #	Hand
39-409	Shown
39-410	Opposite

Dual Arm Operator Bracket, E-Gard Finish

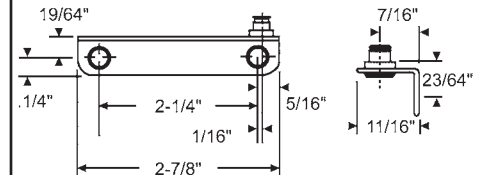

Part #	Hand
39-411	Shown
39-412	Opposite

Dual Arm Operator Bracket, E-Gard Finish

Window Replacement Hardware

Casement and Awning Operator Brackets

TRUTH HARDWARE

OLD STYLE

Part #	Hand
39-299	Shown
39-298	Opposite
39-299CG (CoastGard)	Shown
39-298CG (CoastGard)	Opposite

Clip-on Type

TRUTH HARDWARE

OLD STYLE

Part #	Hand
39-21	Shown
39-21SS (Stainless Steel)	Shown
39-22	Opposite
39-22SS (Stainless Steel)	Opposite

Snap-on Type

TRUTH HARDWARE

Part #	Hand
39-9 (E-Gard)	Shown
39-10 (E-Gard)	Opposite
39-9CG (CoastGard)	Shown
39-10CG (CoastGard)	Opposite

Stud Bracket

TRUTH HARDWARE

Part #	Hand	Clip Type
39-534 (E-Gard)	Shown	Snap Stud
39-535 (E-Gard)	Opposite	Snap Stud
39-534CG (CoastGard)	Shown	Snap Stud
39-535CG (CoastGard)	Opposite	Snap Stud

Stud Bracket

TRUTH HARDWARE

Part #	Hand
39-65	Shown
39-66	Opposite

Stud Bracket

TRUTH HARDWARE

Part #	Hand
39-5	Shown
39-6	Opposite
39-5SS (Stainless Steel)	Shown
39-6SS (Stainless Steel)	Opposite

TRUTH HARDWARE

Part #	Hand
39-7	Shown
39-8	Opposite

Stud Bracket

TRUTH HARDWARE

Part #	Hand
39-50	Shown
39-51	Opposite

Stud Bracket

TRUTH HARDWARE

Part #	Hand
39-52	Shown
39-53	Opposite

Stud Bracket

TRUTH HARDWARE

Part #	Hand
39-15	Shown
39-16	Opposite

Stud Bracket

TRUTH HARDWARE

Part #	Material
39-64	E-Gard
39-64CG	CoastGard

Non-Hand with Snap Stud

TRUTH HARDWARE

Part #	Hand
39-569	Shown
39-570	Opposite

Stud Bracket

Window Replacement Hardware

Casement and Awning Operator Brackets

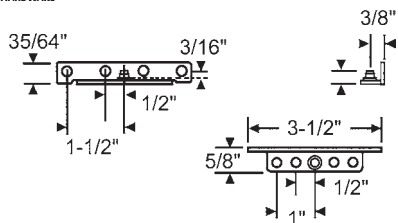

39-418
Non-Hand Snap Stud Bracket

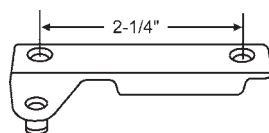

Part #	Hand
750-1361208	Shown
750-1361210	Opposite

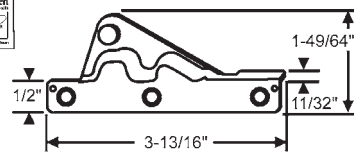

Part #	Hand	Type
750-1361409	Shown	Standard
750-1361408	Opposite	Standard
750-1361411	Shown	Corrosion Resistant
750-1361410	Opposite	Corrosion Resistant

Sash Bracket for 750-1361484

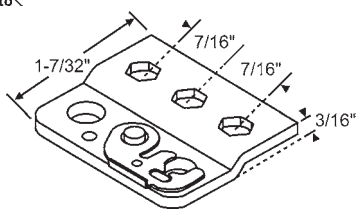

Part #	Hand
39-737LH	Shown
39-737RH	Opposite

Sash Bracket

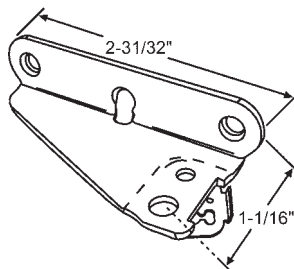

Part #	Hand
39-698	Shown
39-699	Opposite

Sash Bracket Assembly, 35mm, Facemount

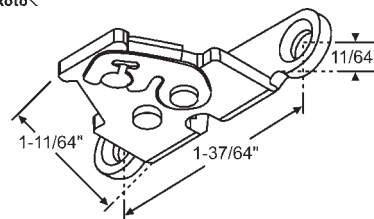

Part #	Hand
39-700	Shown
39-701	Opposite

Sash Bracket Assembly, 30mm, Facemount

Operator Covers

MAXIM® OPERATOR COVER



Plastic Nesting Cover for Maxim® Operators

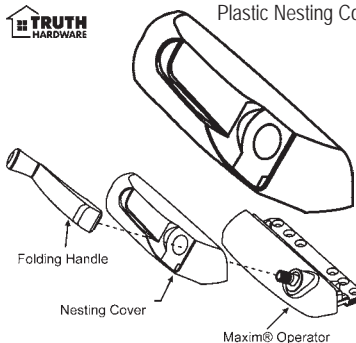

Converts Crank Handle to Folding Handle. Just Snap on Top of Operator.

Part #	Hand	Finish
36-368NCV-1	Shown	Bronze
36-369NCV-1	Opposite	Bronze
36-368NCV-3	Shown	White
36-369NCV-3	Opposite	White

Furnished with Double Sided Tape Pre-Applied to Cover for Attaching Cover to Maxim® Operator

TRUTH'S ENCORE™ TANGO FOLDING HANDLE & COVER

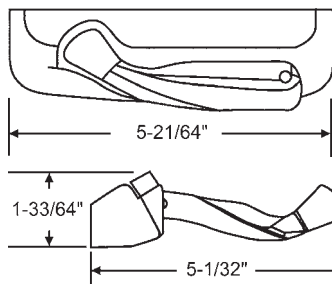

Part #	Hand	Finish
37-215-1	Shown	Bronze
37-216-1	Opposite	Bronze
37-215-3	Shown	White
37-216-3	Opposite	White
37-215-71	Shown	Oil Rubbed Bronze

ENTRYGARD FOLDING HANDLE & COVER

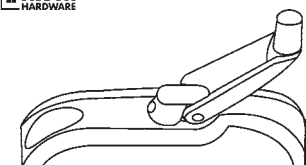

Non-Hand. Fits All Entrygard Products
Converts Crank Handle to a Folding Handle. Just Remove Handle & Cover, and Install over Operator.

Part #	Finish
37-220-3	White

Folding Handle System.
Other Finishes Available

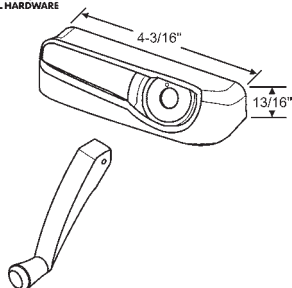

Part #	Hand	Finish
37-237LH-3	Shown	White
37-237RH-3	Opposite	White

Plastic Nesting Cover and Folding Handle.
Fits all Truth Series 15 & Ellipse

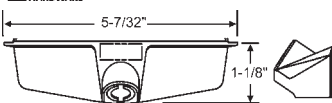

Part #	Finish
36-173CV-1	Bronze
36-173CV-2	Gold
36-173CV-3	White
36-173CV-5	Brass
36-173CV-6	Clay
36-173CV-8	Chestnut Bronze
36-173CV-9	Beige
36-173CV-14	Cocoa Brown
36-173CV-15	Off-White
36-173CV-29	Bright White

Plastic

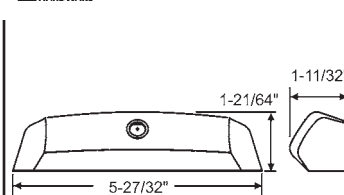

Part #	Finish
36-173MC-1	Bronze
36-173MC-3	White
36-173MC-38	Tuscan Bronze
36-173MC-71	Oil Rubbed Bronze

Metal

TOLL FREE: 800-352-0800

2011 PGI©



Window Replacement Hardware

Operator Covers

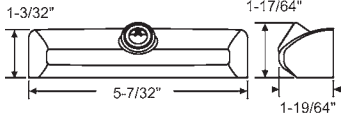

Part #	Finish
36-173PCV-1	Bronze
36-173PCV-2	Gold
36-173PCV-3	White

Plastic Contour Cover

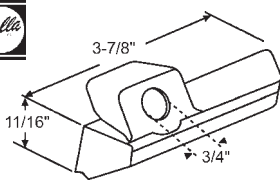

Part #	Hand	Finish
36-201LH	Shown	Copperite
36-201RH	Opposite	Copperite
36-201LHW	Shown	White
36-201RHW	Opposite	White
36-201LHCHP	Shown	Champagne
36-201RHCHP	Opposite	Champagne

Square Cover

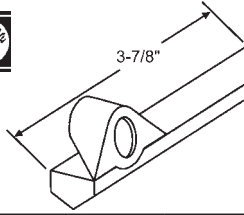

Part #	Hand	Finish
36-202LHW	Shown	White
36-202RHW	Opposite	White
36-202LHCHP	Shown	Champagne
36-202RHCHP	Opposite	Champagne
36-202LHBP	Shown	Bright Brass Plated
36-202RHBP	Opposite	Bright Brass Plated

Round Cover

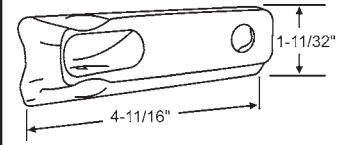

Part #	Hand	Finish
36-219RHCHP	Shown	Champagne
36-219LHCHP	Opposite	Champagne
36-219RHBP	Shown	Bright Brass Plated
36-219LHBP	Opposite	Bright Brass Plated
36-219RHW	Shown	White
36-219LHW	Opposite	White

Integrated Folding Handle Cover

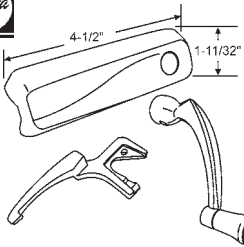

Part #	Hand	Finish
36-505LHCHP	Shown	Champagne
36-505RHCHP	Opposite	Champagne
36-505LHW	Shown	White
36-505RHW	Opposite	White

Crank Kit

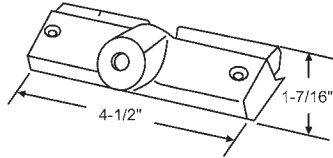

Part #	Finish
750-0532610	Stone
750-1351330	White

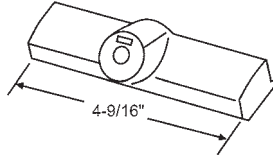

Part #	Finish
750-0532608	Stone

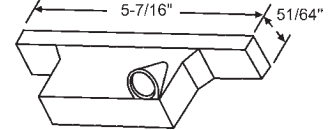

Part #	Hand	Finish
36-333CV-54	Shown	Brown
36-333CV-28	Shown	Almond
36-333CV-1	Shown	Bronze
36-333CV-10	Shown	Black
36-334CV-10	Opposite	Black

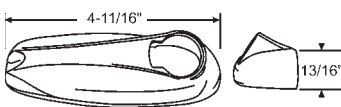

Part #	Hand	Finish
37-225BCH	Shown	Bright Chrome
37-226BCH	Opposite	Bright Chrome
37-225BRS	Shown	Brass Plated
37-226BRS	Opposite	Brass Plated
37-225ORBZ	Shown	Oil Rubbed Bronze
37-226ORBZ	Opposite	Oil Rubbed Bronze

Metal. Other Finishes Available

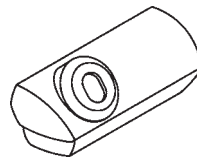

Part #	Finish
750-1361530	Stone
750-1361529	White

Classic Style



Part #	Finish
750-1361531	Stone
750-1361532	White

Metro Style

Crank Handles

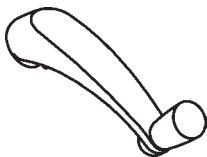

Part #	Finish
750-1361358	Stone
750-1361356	White

Classic Crank Handle with 3/8" Spline. Used with Classic Operator Cover 750-1361530



Part #	Finish
750-1361360	Stone
750-1361362	White

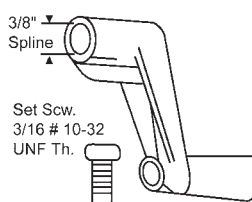

Part #	Finish
750-0532308	Bronze

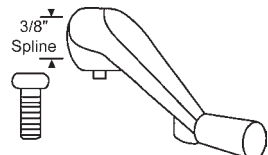

Part #	Finish
750-0532408	Stone
750-1351332	White

Window Replacement Hardware

Crank Handles

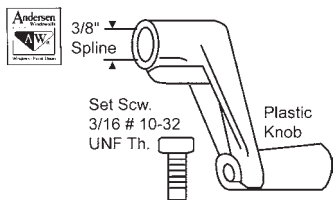

Part #	Finish
750-1361008	Silver

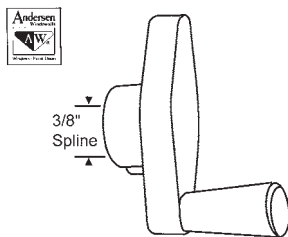

Part #	Finish
750-1361804	Stone

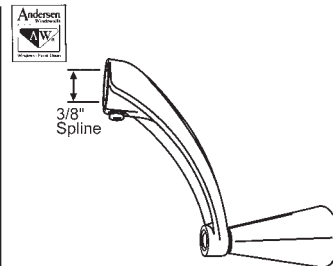

Part #	Finish
750-1361378	Stone
750-1361377	White

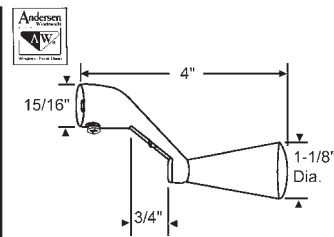

Part #	Finish
750-1361806	Stone
750-1351335	White

Easy Grip Handle

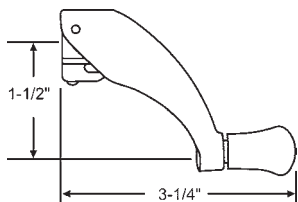

Part #	Finish
37-203-45	Blue White

Folding Crank Handle, 3/8" Spline
Fits Andersen

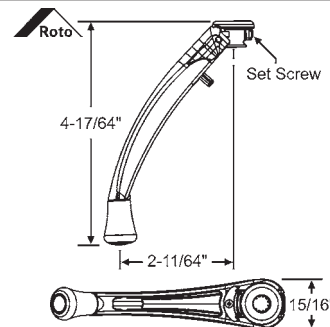

Part #	Finish
37-224W	White
37-224BCH	Bright Chrome
37-224BRS	Brass Plated
37-224ORBZ	Oil Rubbed Bronze

For X-Drive Operators.
Other Finishes Available.

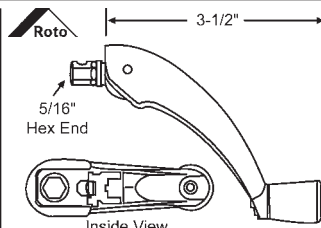

Part #	Finish
37-221BEW	Blue White
37-221W	White
37-221AD	Almond
37-221DBR	Dark Bronze
37-221EB	Earth Brown
37-221LAD	G2 Almond
37-221ORBZ	Oil Rubbed Bronze
37-221SV	Silver
37-221EW	G2 White

Folding Handle For Roto Pro Drive Operators

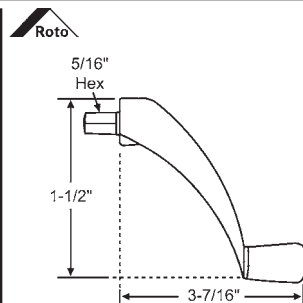

Part #	Finish
37-209BEW	Blue White
37-209W	White

For Roto Pro Drive Operators

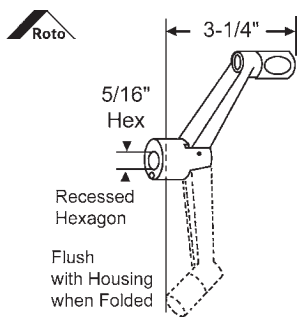

Part #	Finish
37-160W	White

Folding Crank Handle with Hex Broach

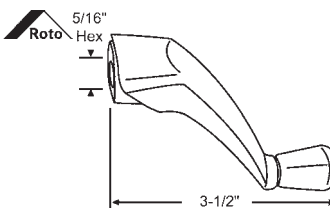

Part #	Finish
37-213BEW	Blue White
37-213AD	Almond
37-213CY	Clay
37-213EW	Euro White
37-213W	White

Folding Handle

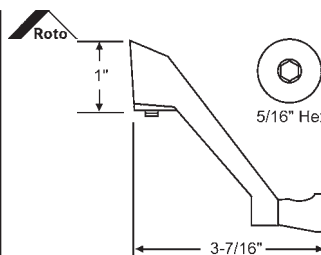

Part #	Finish
37-157W	White
37-157BEW	Blue White
37-157	Almond

With Set Screw

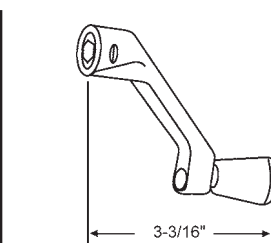

Part #	Finish
37-159WH	White
37-159	Aluminum

Fits Roto Operators 36-333SP, 36-334SP
5/16" Hex

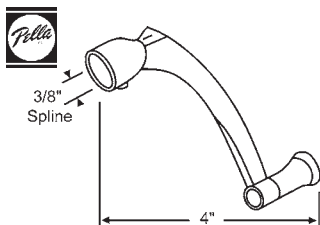

Part #	Finish
900-8869	Copperite
900-8869CH	Champagne
900-8869WH	White
900-8869BR	Brass Plated

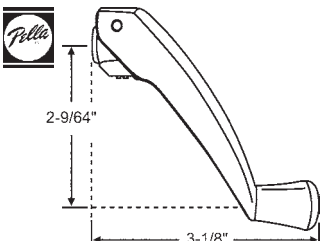

Part #	Finish
900-8869BR-F	Brass
900-8869W-F	White
900-8869CH-F	Champagne

Folding Handle



Part #	Finish
37-207W	White
37-207CHP	Champagne
37-207BP	Brass Plated

Integrated Crank Handle

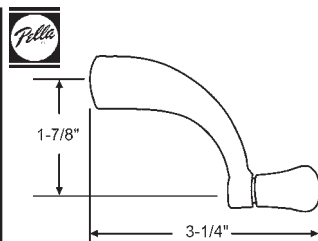

Part #	Hand	Finish
37-201-45	Shown	Blue White
37-202-45	Opposite	Blue White

TOLL FREE: 800-352-0800

2011 PGI©

strybuc

201

Window Replacement Hardware

Crank Handles

TRUTH OPERATOR HANDLES (ONLY FIT TRUTH 11/32" SPLINE)

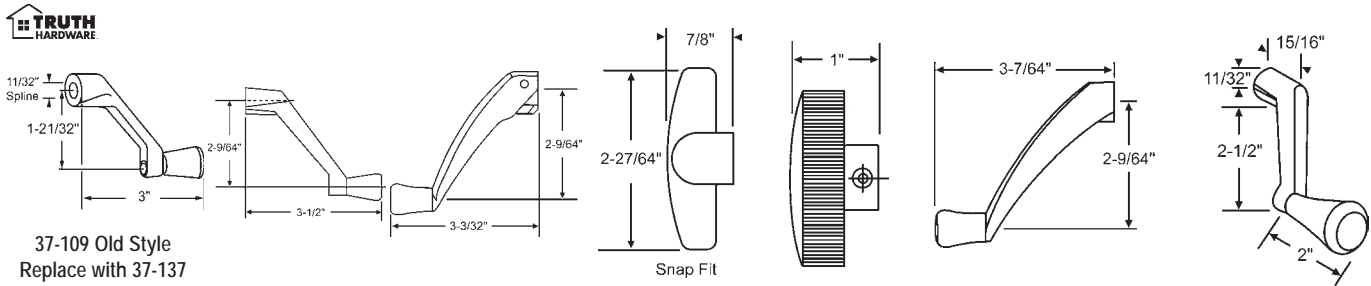

37-109 Old Style
Replace with 37-137

Finish	Long	Folding	"T"	Round	Contour Handle	ADA
Bronze	37-137-1	37-109FH-1	37-140-1	37-138-1	37-150-1	37-149-1
Gold	37-137-2	37-109FH-2	37-140-2	37-138-2	37-150-2	-
White	37-137-3	37-109FH-3	37-140-3	37-138-3	37-150-3	37-149-3
Brass	37-137-5	37-109FH-5	37-140-5	-	37-150-5	37-149-5
Clay	37-137-6	37-109FH-6	37-140-6	37-138-6	37-150-6	-
Aluminum	37-137-7	37-109FH-7	37-140-7	37-138-7	37-150-7	-
Chestnut Bronze	37-137-8	37-109FH-8	37-140-8	37-138-8	37-150-8	37-149-8
Beige	37-137-9	37-109FH-9	37-140-9	37-138-9	37-150-9	37-149-9
Medium Bronze	37-137-12	-	-	-	-	-
Brush Copper Nickel	37-137-13	37-109FH-13	37-140-13	-	37-150-13	37-149-13
Off-White	37-137-15	37-109FH-15	37-140-15	-	-	37-149-15
Black	37-137-10	37-109FH-10	37-140-10	-	37-150-10	-
Coppertone	37-137-75	37-109FH-75	-	37-138-75	37-150-75	-
Cocoa Brown	37-137-14	-	37-140-14	-	37-150-14	-
Bright White	37-137-29	37-109FH-29	37-140-29	-	37-150-29	-
Tuscan Bronze	37-137-38	37-109FH-38	-	-	37-150-38	-
Oil Rubbed Bronze	37-137-71	37-109FH-71	37-140-71	-	37-150-71	-
Gold (New)	37-137-87	37-109FH-87	-	-	37-150-87	-

Other finishes available. Check with your account manager.

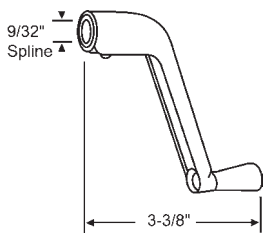

Part #	Finish
900-9690	Driftwood
900-9690W	White
900-9690B	Polished Brass

Peachtree

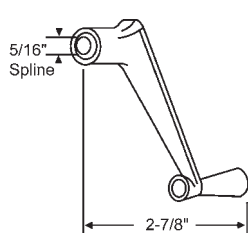

Part #	Finish
37-102	Aluminum
37-103	Light Bronze

Dorchester

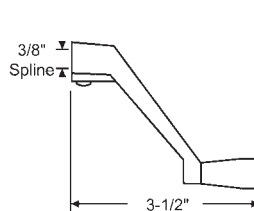

Part #	Finish
37-212	Aluminum
37-212BZ	Bronze
37-212W	White

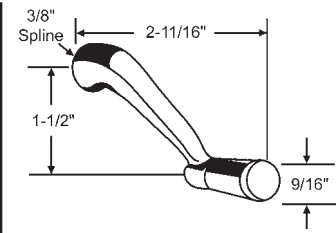

Part #	Finish
37-100	Aluminum
37-101	Brown
37-100W	White
37-101B	Bronze

Window Replacement Hardware

Crank Handles

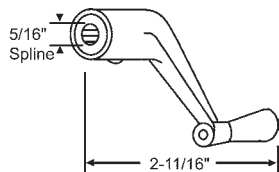

Part #	Finish
37-112	Aluminum
37-111	Brown
37-112DB	Dark Bronze

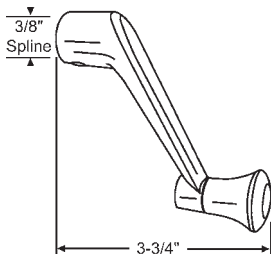

Part #	Finish
37-210	Mill

Yale

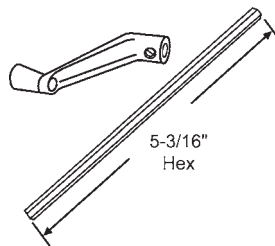

Part #	Finish
37-147	Mill

5/16" Hex Handle and Shaft

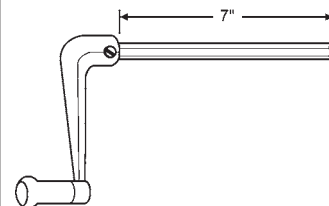

Part #	Finish
900-10738	Mill

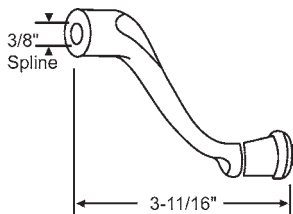

Part #	Finish
37-104	Aluminum
37-104W	White
37-105	Brown

For Awning Operators

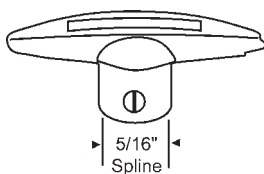

Part #	Finish
37-120	Mill
37-120B	Bronze

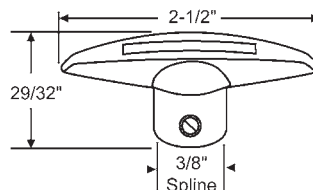

Part #	Finish
37-119	Aluminum
37-119B	Bronze
37-119W	White

Fits Old Style Steel Casement Operators

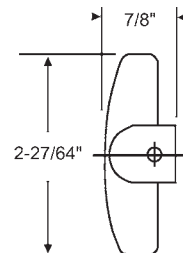

Part #	Finish
37-125-1	Bronze
37-125-3	White
37-125-4	Coppertone
37-125-8	Chestnut Bronze
37-125-9	Beige

Fits All Truth Operators with 11/32" Spline

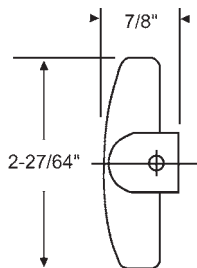

"T" Handle

Part #	Fits Mfg.	Spline Style	Finish
37-124	Pella	3/8-11	Copperite
37-124W		3/8-11	White
37-124CH		3/8-11	Champagne
37-126	Andersen	3/8	Stone
37-126W		3/8	White
37-123	Peachtree	9/32"	Driftwood
37-123W		9/32"	White
37-113	Old Style	3/8	Aluminum
37-113W	Steel	3/8	White
37-113B	Casement	3/8	Brown

Part #	Fits Mfg.	Spline Style	Finish
37-106	Old Style Steel	5/16	Aluminum
37-106B	Casement	5/16	Brown
900-161	Jalousie	5/16	Aluminum
37-127		7/16	Bronze

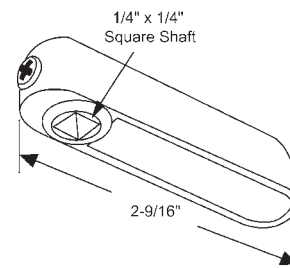

Part #	Finish
900-21337-BG	Driftwood
900-21337-W	Brown

PVC Replacement Peanut Latch

Peachtree

Spline Gauge

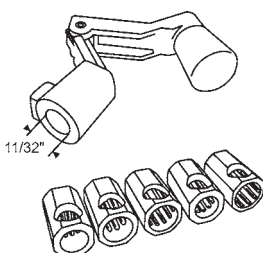

Part #	Finish
37-165U-2	Gold
37-165U-24	Brown
37-165U-3	White
37-165U-7	Aluminum
37-165U-75	Coppertone
37-165U-9	Beige
37-165U-MTBZ	Metallic Bronze

Fit-All Folding Handle Kit. Includes 5 adapters: 11/32", 5/16", 3/8", 9/32", 3/8" special. Will fit Truth, Andersen, Pella, Peachtree and various old style casement and jalousie operators

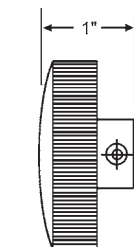

Round Hand Knob

Part #	Fits Mfg.	Spline Style	Finish
37-133	Pella	3/8-11	Copperite
37-133W		3/8-11	White
37-133-35		3/8-11	Champagne
37-129	Andersen	3/8	Stone (Dark Gray)
37-129W		3/8	White
37-128	Peachtree	5/16	Light Brown

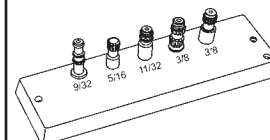

59-68

Operator Handle Spline Gauge

TOLL FREE: 800-352-0800

2011 PGI®

strybuc

203

Window Replacement Hardware

Push Bars

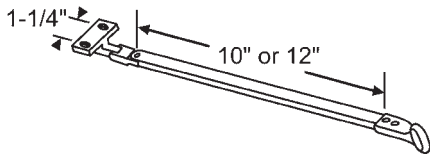

Part #	Length
29-105-10A	10"
29-105-12A	12"

Aluminum

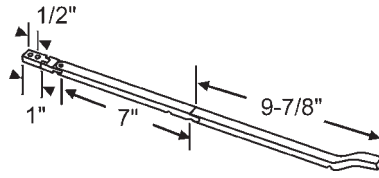

29-107
Aluminum

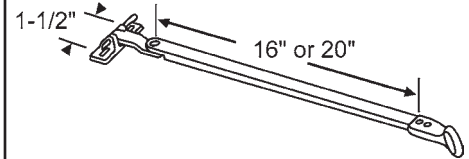

Part #	Length
29-109-16A	16"
29-109-20A	20"

Aluminum with Nickel Bronze Ends

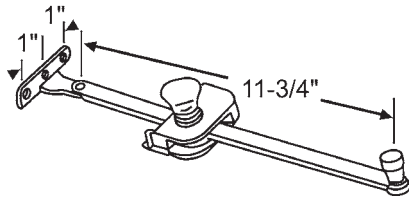

Part #	Hand
36-120	Shown
36-121	Opposite

Black Housing & Push Bar with Bracket. 29-110 Available Upon Request

Fenestra

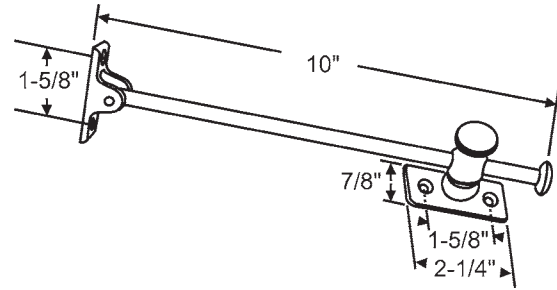

Part #	Length
900-339	Bright Nickel
900-339BRS	Bright Brass

Casement Adjuster

Telescoping Push Bars

Anderberg 44AL Series
For Aluminum Windows

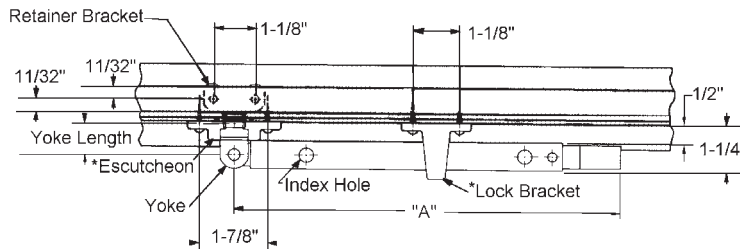

These Items Can Be Purchased Separately

39-124-7

Lock Bracket

39-158-7

Nylon Escutcheon

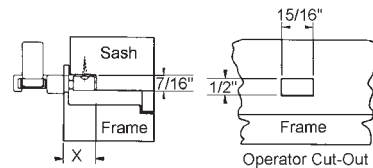

Truth Part #	Our Part #	X Dimension	Yoke Length	A Dimension		Finish
				Closed	Extended	
12.40.00.100	29-131-7	15/16"	25/32"	10-1/2"	16-1/4"	Aluminum
12.41.00.100	29-132-7	1"	27/32"	10-1/2"	16-1/4"	Aluminum
12.42.00.100	29-133-7	1"	27/32"	8"	11"	Aluminum
12.46.03.100	29-137-1	1-9/16"	1-13/32"	8"	11"	Bronze

Window Replacement Hardware

Telescoping Push Bars



Anderberg 44WD Series
For Wood Windows

These Items Can Be Purchased Separately

39-124-7

Lock Bracket

39-158-7

Nylon Escutcheon

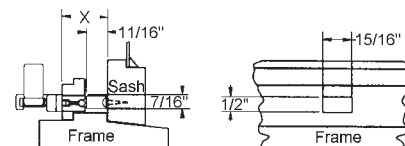
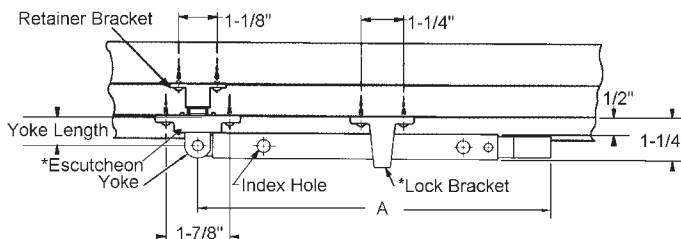

Truth Part #	Our Part #	X Dimension	Yoke Length	"A" Closed	"A" Extended	Finish
12.48.00.100	29-142-7	15/16"	25/32"	8"	11"	Aluminum
12.50.00.100	29-145-7	1"	27/32"	8"	11"	Aluminum
12.52.00.100	29-150-7	1-7/16"	1-9/32"	8"	11"	Aluminum
12.54.00.100	29-153-7	2"	27/32"	8"	11"	Aluminum

Vent Arms With Brackets

Our machine shop facilities can duplicate a variety of sizes and shapes of vent arms.

The drawings below are just a representation of the various vent arms that are available. Please send us your sample so we can provide an exact replacement.

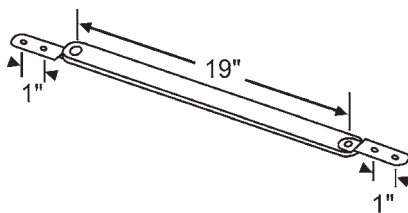
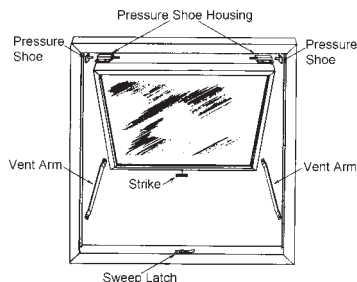

28-50
2 Brackets. Aluminum

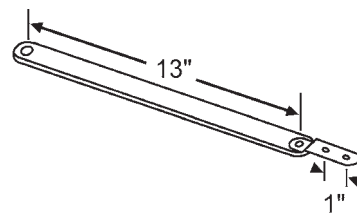

28-51
1 Bracket. Aluminum

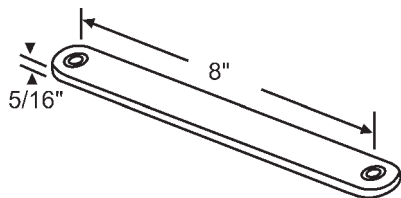

28-52
Aluminum
Bushing Only: 8-361

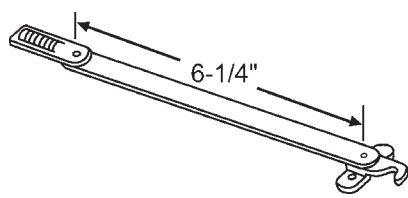

28-53
Aluminum with Nylon End Piece and Hook. Set Includes Right Hand and Left Hand

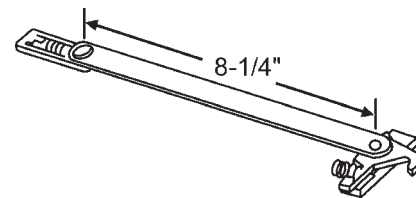

28-61
Aluminum with Nylon End Piece and Hook. Set Includes Right Hand and Left Hand

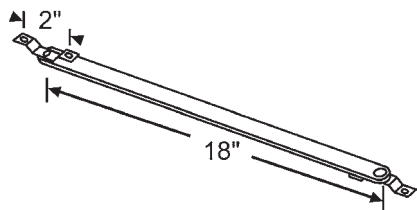

28-55
Aluminum

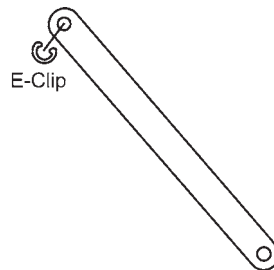

Part #	Description
28-79A	for 24" Wide Vent
28-79B	for 18" Wide Vent
28-79C	for 30" to 36" Wide Vent

Drag Arm
Peachtree

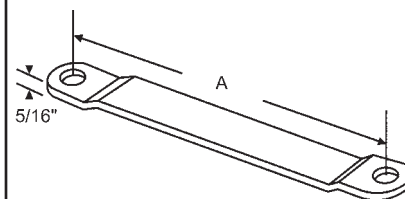

Part #	"A"
900-10601	7-3/4"
900-10602	18-1/4"

Aluminum

TOLL FREE: 800-352-0800

2011 PGI©

strybuc
FINE LULU STATE

205

Window Replacement Hardware

Pressure Shoes, Friction Shoes & Housings

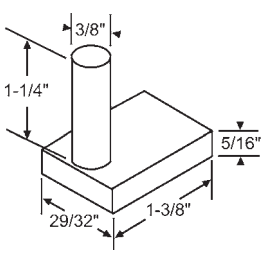

26-118

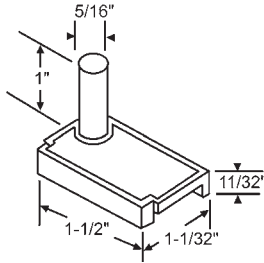

Part #	Hand
26-121	Shown
26-120	Opposite

Nylon Shoes

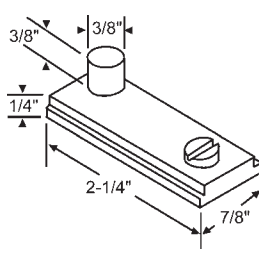

Part #	Hand
26-59	Shown
26-58	Opposite

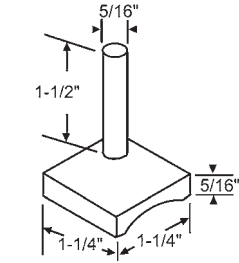

Part #	Hand
26-66	Shown
26-65	Opposite

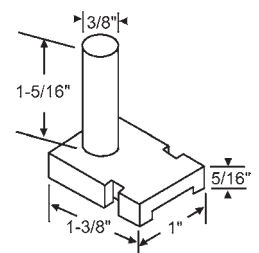

26-68
Notched

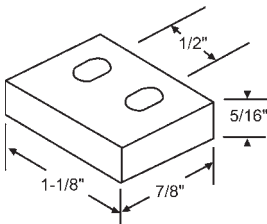

26-76
Housing Only

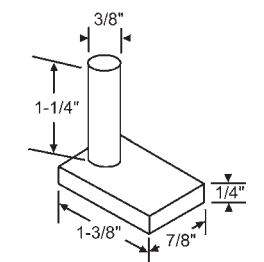

Part #	Hand
26-111	Shown
26-110	Opposite

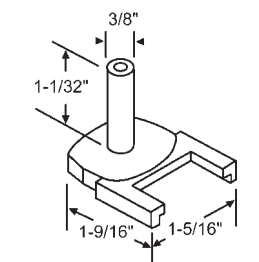

26-100

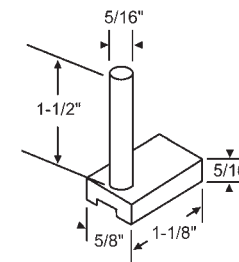

26-101

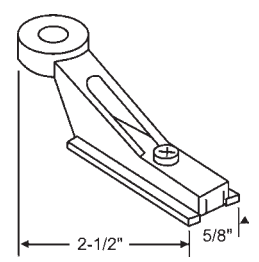

26-102

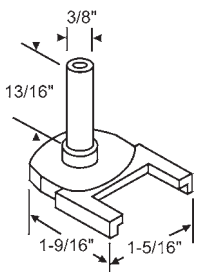

26-103
Used with Bushing 8-361

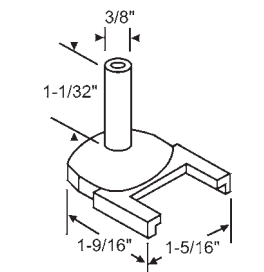

26-104

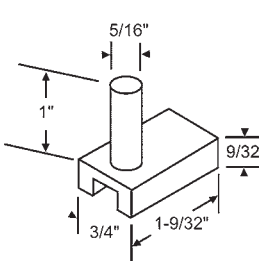

26-105

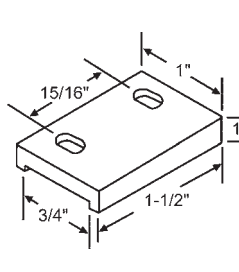

26-116

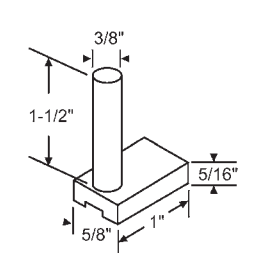

26-117

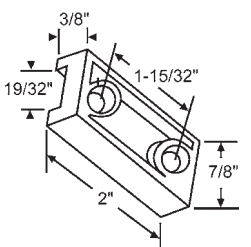

26-123

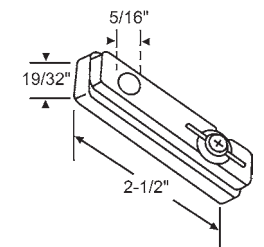

26-122

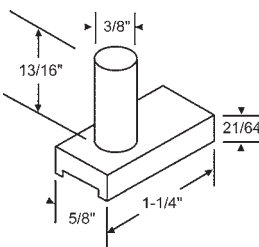

26-55
Metal Pin

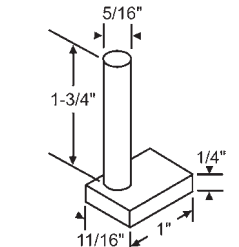

Part #	Hand
26-57	Shown
26-56	Opposite

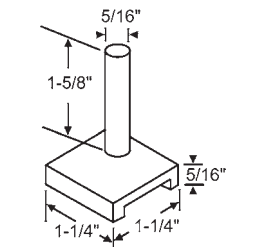

Part #	Hand
26-63	Shown
26-62	Opposite

Window Replacement Hardware

Pressure Shoes, Friction Shoes & Housings

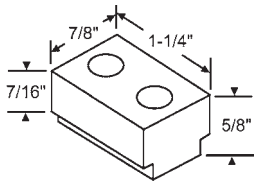

26-67
Aluminum

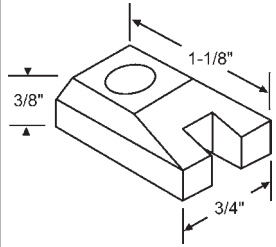

26-74

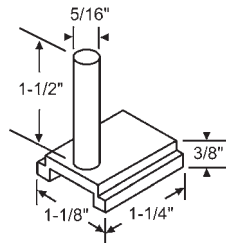

26-69

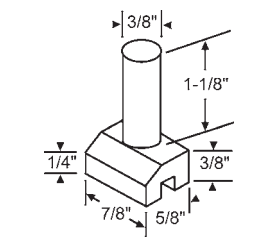

Part #	Base Type
26-72	Nylon

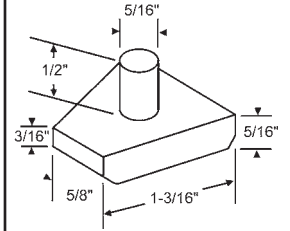

26-81

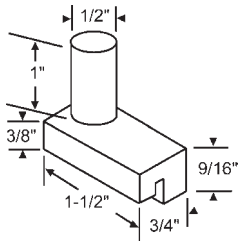

Part #	Hand
26-84	Shown
26-83	Opposite

Pressure Shoe with Aluminum Pin

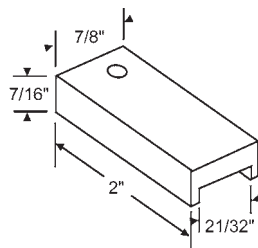

Part #	Hand
26-86	Shown
26-85	Opposite

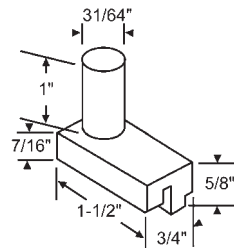

Part #	Hand
26-88	Shown
26-87	Opposite

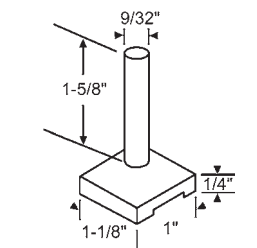

Part #	Hand
26-99	Shown
26-98	Opposite

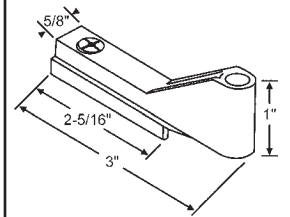

900-20957
Metal Bracket

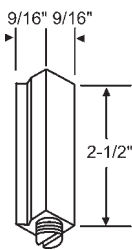

26-113
Housing with Screw.
Aluminum

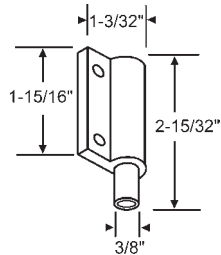

Part #	Hand
26-119	Shown
26-114	Opposite

Aluminum

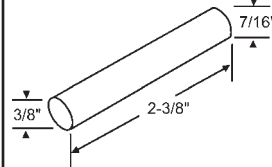

26-115
Pressure Shoe Pin

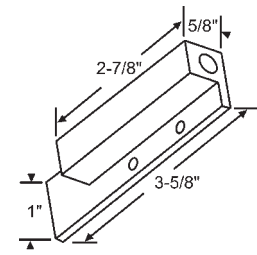

Part #	Hand
26-61	Shown
26-60	Opposite

Aluminum

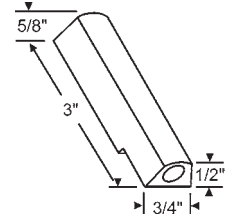

26-75
Three 10-24 Tapped Mounting
Holes on Underside; Set Screw
Only: 26-75S

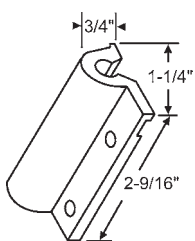

Part #	Hand
26-80	Shown
26-79	Opposite

Aluminum

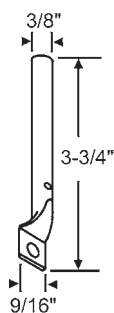

26-82
Brass

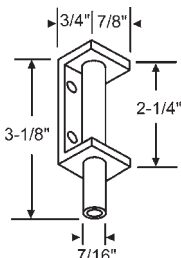

26-89
Aluminum

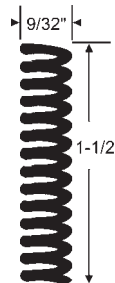

900-12627
Pressure Shoe Spring
.50 Gauge Steel.

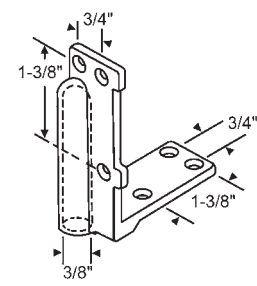

Part #	Hand
26-129	Shown
26-128	Opposite

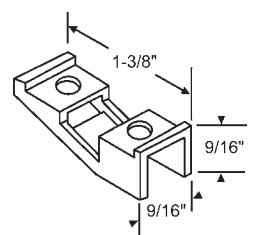

26-124
Project Out Guide